

Illinois

McLean County Cemetery LOCATIONS

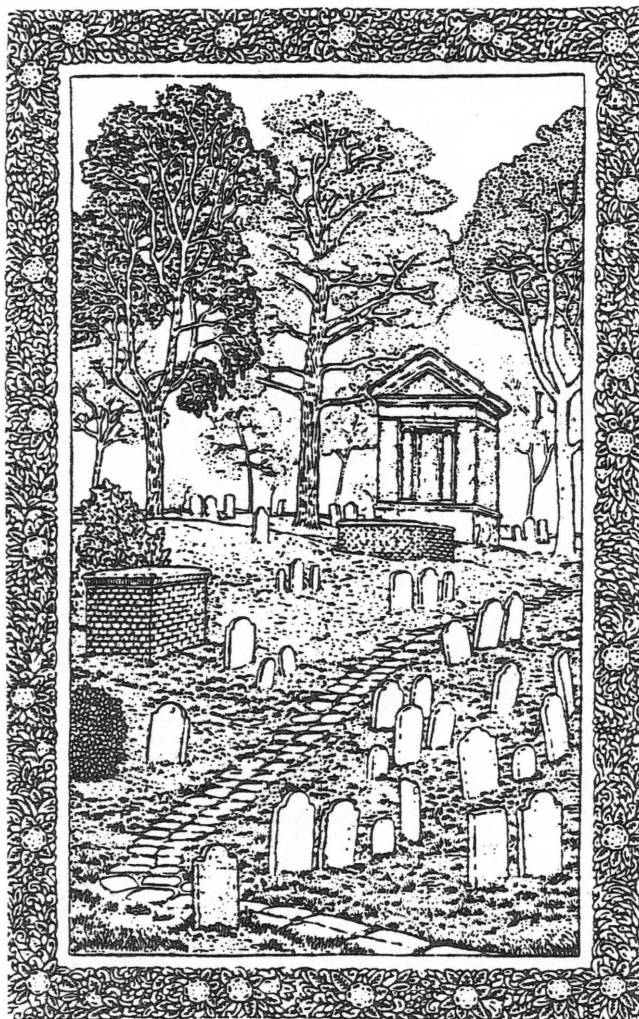

UMCL-1

**Compiled by Liz Veselack, MCGS
March 1993**

**Published and Copyrighted 1993 by:
The McLean County Genealogical Society**

THIS PUBLICATION HAS BEEN ASSEMBLED BY USING THE MATERIAL AS IT APPEARED IN "GLEANINGS FROM THE HEART OF THE CORNBELT", VOLUME 26, No. 3 AND VOLUME 27, No. 1.

Publications Committee, The McLean
County Genealogical Society

MCLEAN COUNTY CEMETERIES

We find these McLean County cemeteries, burial grounds, family burial plots, etc., referred to in various sources. The old county plat books, county history books, publications of the McLean County Historical Society, cemetery recordings of the Daughters of the American Revolution, published material from the Lexington Historical and Genealogical Society and publications of our group, The McLean County Genealogical Society, all provide bits and pieces of cemetery information.

Some of the cemeteries which are no longer in existence may have been recorded many years ago; therefore, cemetery records may exist even though the site is now a farmed field, part of a highway or a subdivision filled with homes.

In this and future issues, we will provide basic information about the existing cemeteries. A township map with cemeteries marked will be accompanied by directions for driving to the site.

We also plan to prepare a book of McLean County Cemeteries which will include, in addition to the previously mentioned map and directions, a bit of history about the existing cemeteries and, when available, a plat showing the configuration of the burial plots.

Information gathered on cemeteries no longer in existence will be included in this future publication.

Liz Veselack

GLEANINGS Vol. 26 No. 3

McLEAN COUNTY CEMETERIES

Our fall and winter quarterlies have contained maps and written directions for locating many of the existing cemeteries of McLean county. In this issue we present the remaining maps and directions. In using the information provided in the three publications, it may help to remember that all directions, unless otherwise stated, use Bloomington-Normal, IL as a starting point.

It would also be helpful to have a McLean county map as an added reference when using these publications. This would give you the overall picture of township locations and better show you how they relate to the twin cities. These maps are available at several area bookstores, gas stations, realtor offices and various other businesses. A map is also available at the McLean County Historical Society Museum gift shop.

Perhaps you may find the cemetery or cemeteries of interest can be more easily seen by using a 'hi-liter'. Tracing the route and circling the arrow that points to the site should be helpful.

As these cemeteries were visited, it became evident that giving directions for reaching some of them was going to be a challenge. Sometimes, what seemed to be simple to find as we followed oral directions, turned out to be very complicated when transferred to paper. We hope our directions will work for you. PLEASE, if you find errors, let us know.

There are more sites OUT THERE that have a few or one or two stones. We just did not have the time to get to see them and take pictures as proof of their existence. We will continue to search out these sites and report their locations in a future issue. The cemeteries noted in this series of articles, have all been visited within the past year (1992). Pictures of entrance signs, distinctive stones and other noticable features have been made.

Please note, this project did not include reading stones. The reading of stones and updating of cemetery information for McLean county cemeteries is an ongoing project of both the Lexington Genealogical and Historical Society and the McLean County Genealogical Society.

While this has been an enjoyable "mission" it certainly wouldn't have been possible without the many people who have provided information and encouragement; Richard Veselack, Members of the Long Range Planning Committee, Officers and Directors of the MCGS, William Todtz, James Hollis, The Lexington Genealogical and Historical Society and Verda Gerwick.

Liz Veselack

CONTENTS

| | |
|---------------------|---|
| To The Reader ----- | 1 |
|---------------------|---|

| | |
|---------------------|------|
| Township | page |
| ALLIN ----- | 2 |
| ANCHOR ----- | 4 |
| ARROWSMITH ----- | 6 |
| BELLFLOWER ----- | 8 |
| BLOOMINGTON ----- | 10 |
| BLUE MOUND ----- | 14 |
| CHENEYS GROVE ----- | 16 |
| CHENOA ----- | 18 |
| CROPSEY ----- | 19 |
| DALE ----- | 20 |
| DANVERS ----- | 22 |
| DAWSON ----- | 24 |
| DOWNES ----- | 26 |
| DRY GROVE ----- | 28 |
| EMPIRE ----- | 30 |
| FUNKS GROVE ----- | 32 |
| GRIDLEY ----- | 34 |
| HUDSON ----- | 36 |
| LAWNDALE ----- | 38 |
| LEXINGTON ----- | 40 |
| MARTIN ----- | 42 |
| MONEY CREEK ----- | 44 |
| MOUNT HOPE ----- | 46 |
| NORMAL ----- | 12 |
| OLD TOWN ----- | 48 |
| RANDOLPH ----- | 50 |
| TOWANDA ----- | 52 |
| WEST ----- | 53 |
| WHITE OAK ----- | 54 |
| YATES ----- | 56 |

INDEX

To The Reader

This publication contains material on cemetery locations in McLean County Illinois. The following directions and maps were presented in our 1992 Fall and Winter quarterlies and the 1993 Spring quarterly.

Those of you who know the name of the township where the cemetery is located but do not know the name of the cemetery, may find the township listed in the table of contents.

For those who know only the name of the cemetery, please use the index to locate the cemetery by name and then by page.

ALLIN TOWNSHIP T.23N - R.1W

BROOKS GROVE CEMETERY (Section 32)

Leave Bloomington on I-55 south, continuing to the Shirley exit. At Shirley, take 850N to your right (west) out of Shirley. At 500E, turn left (south) and, at 800N, turn right (west). Olympia High School is on this route and easily seen as a landmark. At 150E, turn right (north) and you'll soon see the cemetery on your right.

MT. PLEASANT CEMETERY (Section 15)

Take Route 9 west from Bloomington. At the junction about seven miles from Bloomington, Route 9 will turn right (north). YOU NEED TO CONTINUE west on Route 122 (1400N). This route will turn left (south) toward Stanford. At 1100N, you will turn right (west) and, after one mile, turn right (north) on 300E. The cemetery will be on your right (east).

| | | | | | | |
|------------|-------------|--------------|-------------|------------|-------------|--------------|
| | | | GRIDLEY | CHENOA | YATES | |
| | | HUDSON | MONEY CREEK | DEX-INGTON | LANH-DALE | CROFSEY |
| WINTER | DRY GROVE | NORMAL | TOMANDA | BLUE MOUND | MARTIN | ANCHOR |
| ALLIN | DALE | BLOOM-INGTON | OLD TOWN | DANSON | ARROW-SMITH | CHENEY GROVE |
| MOUNT HOPE | PUNKS GROVE | RAN-DOLPH | DOWNES | EMPIRE | WEST | PELL-LOWER |

ALLIN
T.23N. - R.1W.

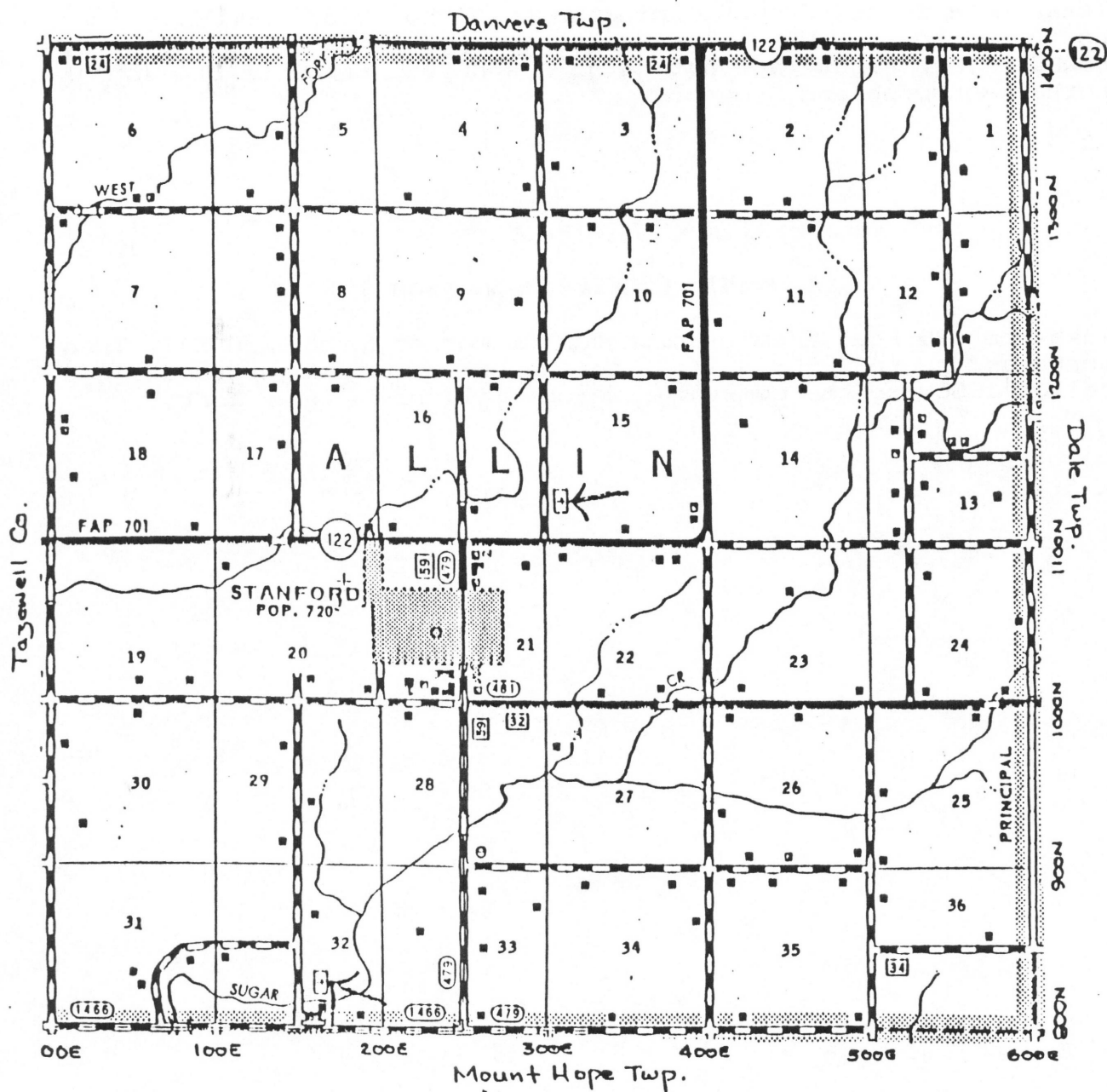

ANCHOR TOWNSHIP T.24N - R.6E

ST. JOHN'S CEMETERY (Section 22)

Take Route 9 East from Bloomington to Anchor Road (3800E). Turn north and go to 1700N. Turn right (east) and go to stop sign at 4000E. Turn right (south) and go a short distance to St. John's Lutheran Church and Cemetery.

TOWNSHIP CEMETERY (Section 4)

Take Route 9 East from Bloomington to Anchor Road (3800E). Turn north and go to 1900N (almost to Anchor). Turn right (east) and follow 1900N to the cemetery, which will be on your left.

| | | | | | | | |
|---------------|----------------|------------------|----------------|----------------|---------------|--|-----------------|
| | | | GRIDLEY | CHENPA | TATES | | |
| | PHILIP DAK | HUDSON | MOHET CREEK | LEE- INGTON | LAWN- DALE | | PROSE |
| WANTER | DRY GROVE | NORMAL | TOWAND | BLUE MOUND | WATSON | | MICHA |
| | | | | | | | |
| ALLIN | DALE | BLOOM- INGTON | OLD TOWN | JANSON | ARROW BUSH | | HEMET GROVE |
| | | | | | | | |
| MOVIE HOLE | FUNKS GROVE | RAN- DOLPH | DOWNS | INFIRE | WEST | | BELL- FLOWER |

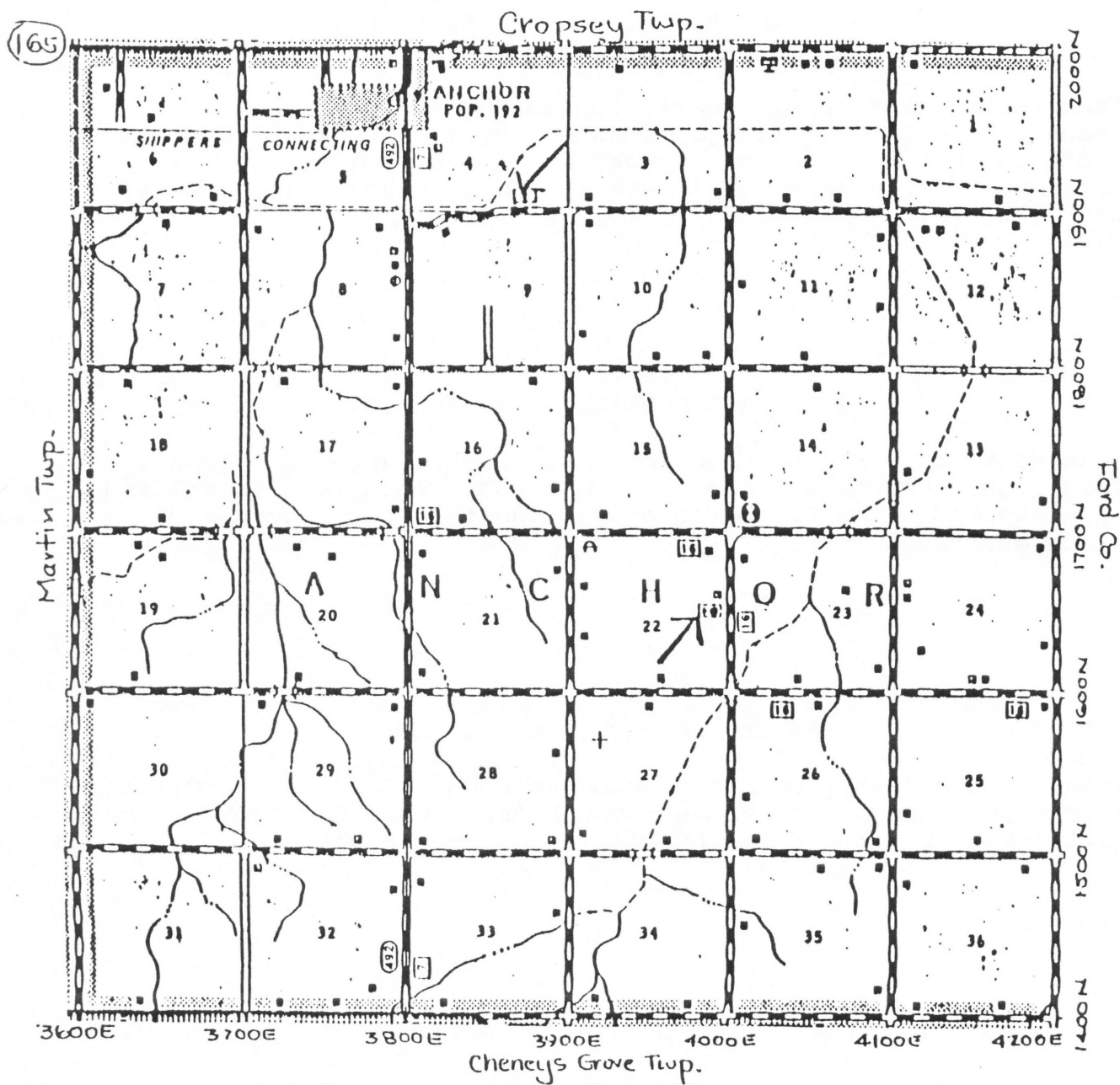

ARROWSMITH TOWNSHIP T.23N - R.5E

ARROWSMITH CEMETERY (Section 20)
(Also known as Stipp or Union)

Take Route 9 East from Bloomington to 3000E. Turn south. After about 2 miles, road will jog as shown on map and then continue south to 1025N. Turn left (east) and about 1 mile more will bring you to the gate post markers. Turn in and drive back to the cemetery.

GREENWOOD CEMETERY (Section 13)

Take Route 9 East from Bloomington to County Road 15 (3300E). Turn right (south) and continue to 1200N. Turn left (east) and then about 3 miles to the cemetery, located at the corner of 1200N and 3600E.

PAYNE CEMETERY (Section 22)

Take Route 9 East from Bloomington to County Road 15 (3300E) and turn right (south) and drive through Arrowsmith to 1100N. Turn left (east) and the cemetery will be on your right.

| | | GRIDLEY | HEHOA | YATES | |
|------------|-------------|--------------|-------------|------------|-------------|
| | WILSON | JUDSON | HONEY CREEK | IRK-INGTON | JAWH-DALE |
| JANVER | DRY GROVE | FORMAL | EDWARD | BLUE MOUND | MARTIN |
| ALLIN | DALE | BLOOM-INGTON | OLD TOWN | JAWSON | ARROW-SMITH |
| MOUNT HOPE | PUNKS GROVE | RAM-DOLPH | DUNNS | ENTIRE | WEST |
| | | | | | PELL-LOWER |

ARROWSMITH

T. 23 N. - R. 5E.

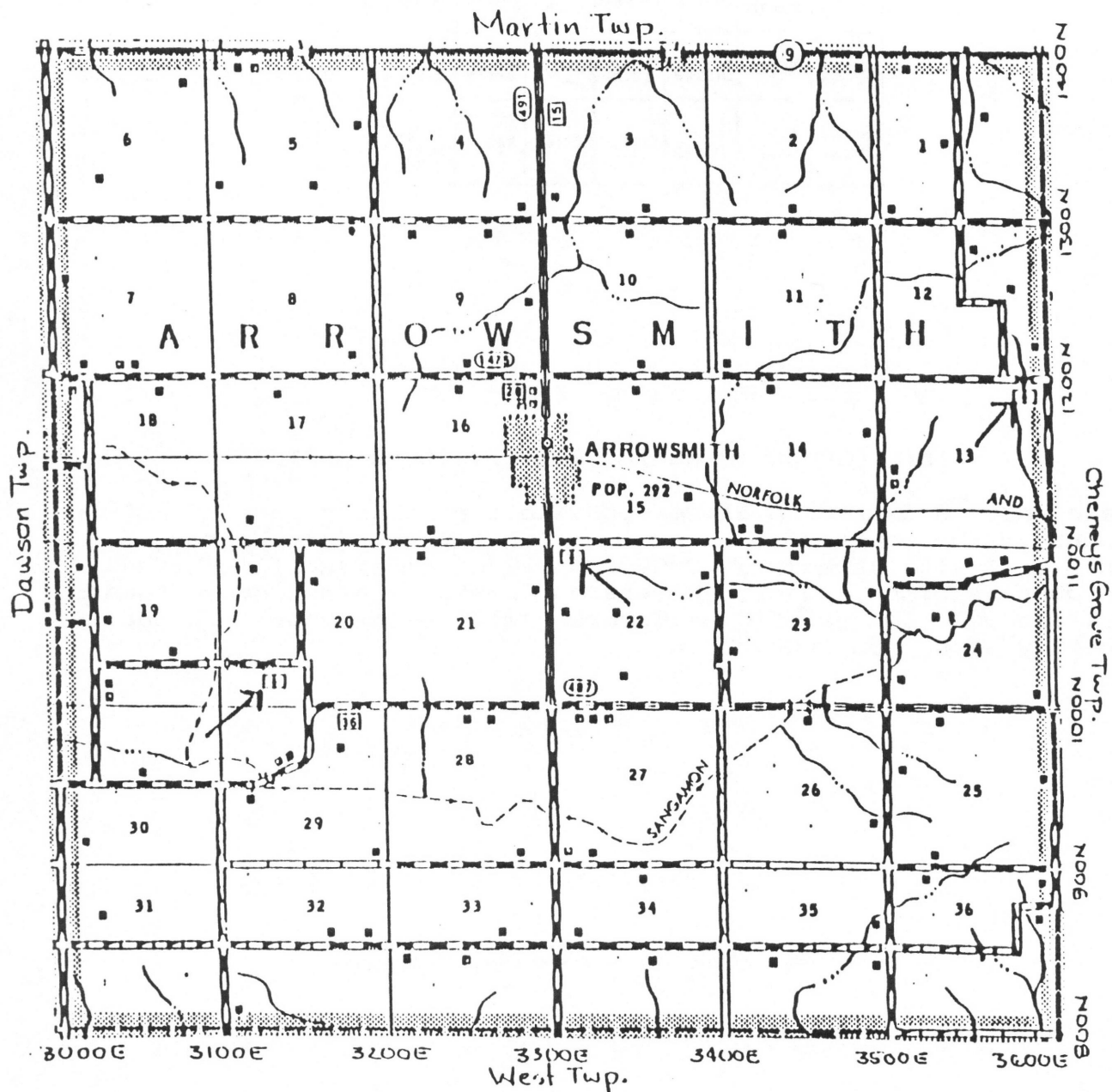

McLEAN COUNTY ILLINOIS

| | | | | | | |
|---------------|----------------|------------------|----------------|----------------|----------------|-----------------|
| | | GRIDLEY | CHENOA | YATES | | |
| | | HUDSON | MONEY CREEK | IZI- INGTON | LANN- DALE | CROPSY |
| JANVER | WHITE OAK | DRY GROVE | NORMAL | TOMANDA | BLUE MOUND | MARTIN |
| ALLIN | DALE | BLOOM- INGTON | OLD TOWN | DANSON | ARROW SMITH | CHENEY GROVE |
| MOUNT HOIE | FUNKS GROVE | RAN- DOLPH | DOWN | EMPIRE | WEST | BELL FLOWER |

BELLFLOWER TOWNSHIP T.21-22N - R.6E

BELLFLOWER TOWNSHIP CEMETERY (Section 16)

Take Route 9 East from Bloomington to the eastern part of McLean County. The route will turn right (south) and join Highway 5. This will also be marked 3850E. Continue on directly south through Saybrook, passing Riverside Cemetery, and proceed toward Bellflower. The Bellflower Cemetery will be on your left (east) shortly after you cross 600N.

BELLFLOWER

T.21-22 N.—R.6E.

Cheneys Grove Twp.

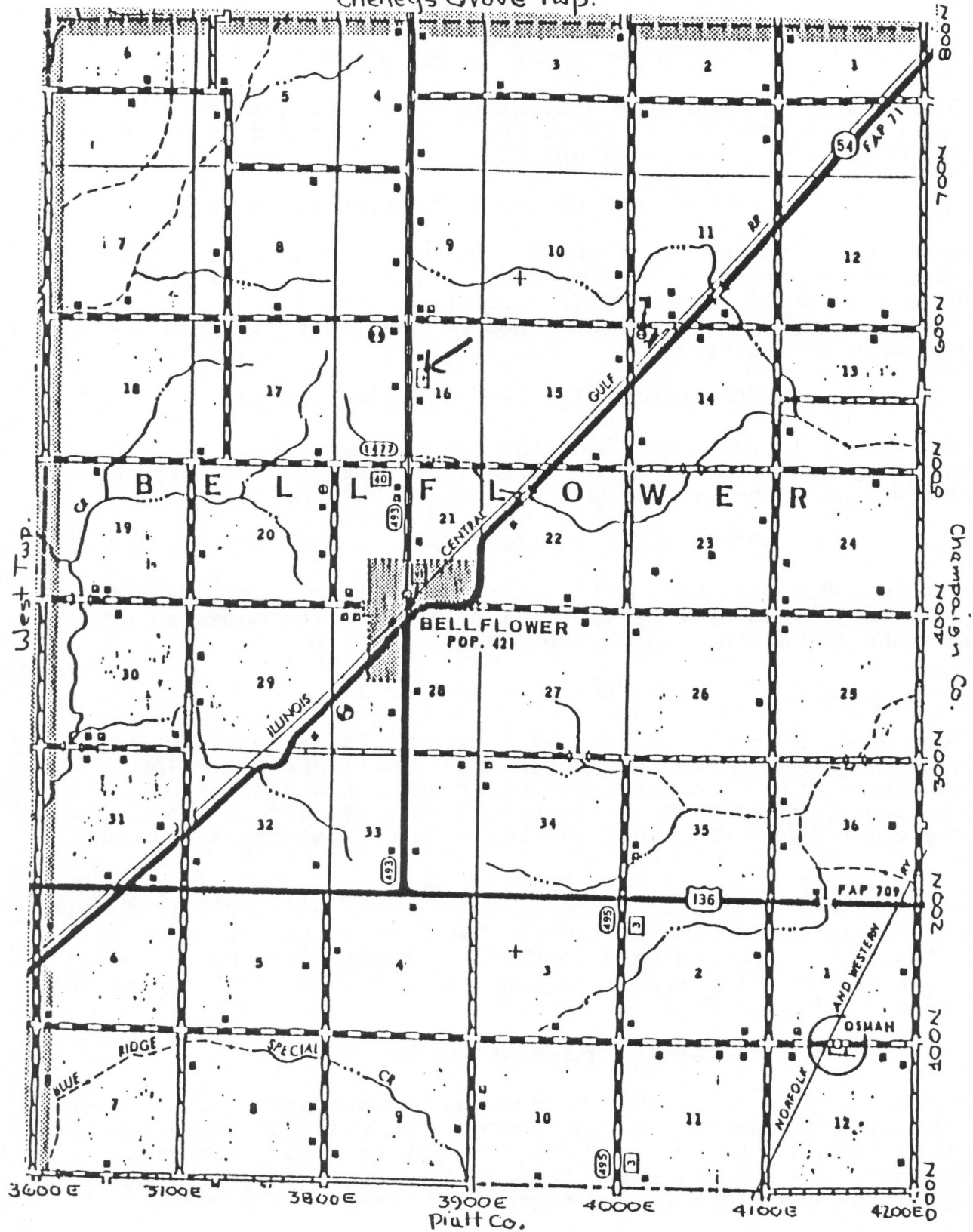

BLOOMINGTON TOWNSHIP T.23N - R.2E

BLOOMING GROVE (Section 27)

From Bloomington, go south on Rte. 51 to 1000N; turn left (E). Continue on this road to the first right (S); turn and go south to the cemetery. It will be on the right (W) side of the road.

COUNTY FARM CEMETERY (Section 29)

This cemetery is not easily accessed and has no names, only numbered, uniformly shaped stones. It lies west of the farm buildings of the former County Farm. Take Rte. 51 south from Bloomington. Shortly after passing 1000N, a tree-lined lane on the right (W) side of the highway leads to the farm.

EVERGREEN/OLD CITY CEMETERY (Section 9)

From the square in downtown Bloomington, take Washington St. west to Madison St., then left (S) to Miller St. and left (E) on Miller until the cemetery entrance appears at the end of the street.

GRASSY RIDGE CEMETERY (Section 32)

Go south from Bloomington on Rte. 51 to 850N; turn right (W) and, after a short distance, turn left (S) on 1375E. The cemetery will be on your left (E) at the side of the road.

JEWISH CEMETERY (Section 17)

In Bloomington, go south on Rte. 51; turn right (W) on Veteran's Parkway and, at the Morris Ave. stoplight, turn left (S). The cemetery is at this intersection. After turning and crossing the oncoming lanes, be prepared to turn left onto the access road. The cemetery drive is on the right (south) side of the access road.

PARK HILL CEMETERY (Section 8)

From the downtown Bloomington square, take Washington St. west to Morris Ave. Turn left (S) and continue on several blocks to the cemetery entrance. It will be on your right (W) and just across from an entrance to Miller Park.

PRICE CEMETERY (Section 15)

Take Morrissey Drive (Rte. 150) to the southeast edge of Bloomington. After crossing Veteran's Parkway, watch for a railroad crossing. DO NOT CROSS! Turn right (W) into the driveway of "Stone Container Corporation". Follow the drive to the rear lot of the property. The cemetery is on the right (N) in a grove of trees.

(BLOOMINGTON TOWNSHIP continued on page 12)

| | | |
|---------|--------|-------|
| ORIDLEY | CHENOA | YATES |
|---------|--------|-------|

T. 23 N. - R. 2 E.

| | | | | | | | |
|---------------|----------------|---------------|-------------|----------------|----------------|-----------------|--------|
| | | | GRIDLEY | CHENOA | YATES | | |
| | | | HUDSON | MONEY CREEK | LEX- INGTON | JAM- DALE | |
| | PHILIP DICK | | | | | | CROSBY |
| JANVER | DRY CROVE | NORMAL | TOMANDA | BLUE MOUND | MARTIN | ANCHOR | |
| ALLIN | DALE | OLD BOSTON | OLD TOWN | DAWSON | ARMON SMITH | CHENEY CROVE | |
| MOUNT HOSE | FUNKS CROVE | RAN- DOLPH | DOWNES | EMPIRE | WEST | PELL- FLOWER | |

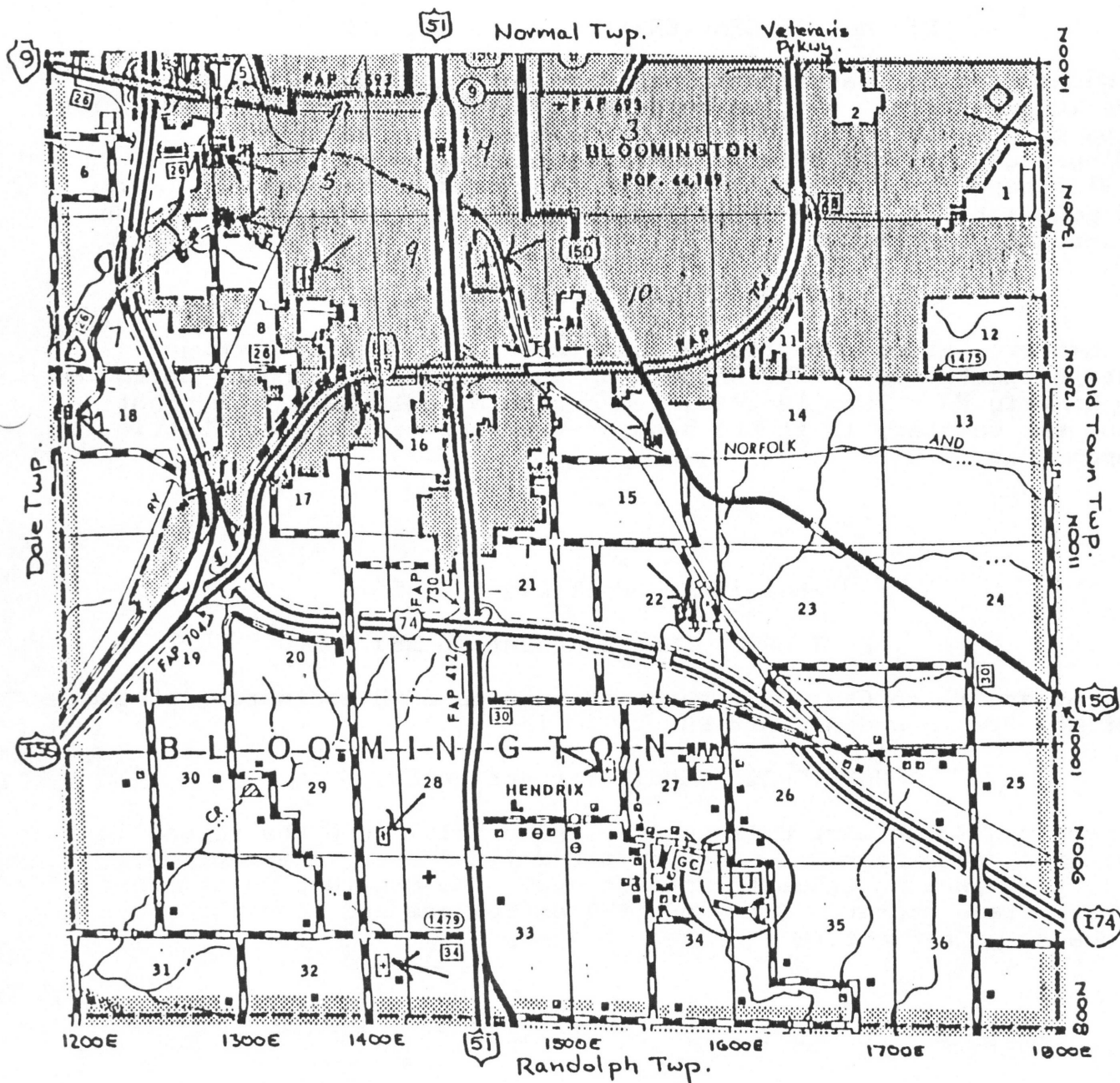

BLOOMINGTON TOWNSHIP (continued)

SCOGIN HILL CEMETERY (Section 18)

See Scogin Hill in DALE TOWNSHIP. Cemetery is in both townships.

ST. JOSEPH'S CEMETERY (Section 8)

Take Oakland Ave. west to the outskirts of Bloomington. At Alexander Rd., turn left (S). The cemetery entrance will appear on the left (E) side of the road.

ST. MARY'S CEMETERY (Sections 5 and 6)

Take Washington St. west through Bloomington to the area beyond the old railroad station. Watch for the tall silo shaped buildings which will be on your left (S). About the time you are near these buildings, you will be able to see a small green sign. This cemetery sign will be on your right (N) and the entrance to the cemetery will be to your left (S). You will cross railroad tracks as you take the road into the cemetery.

WOODLAWN CEMETERY (Section 22)

This cemetery, at present, is accessible only by passing through private property. ASK PERMISSION. Go south from Bloomington on route 51 to Woodrig Rd. Turn left (E) and continue to 1575E. Turn right (S) and the cemetery is in the area just before crossing the Little Kickapoo Creek.

NORMAL TOWNSHIP T.24N - R.2E

EAST LAWN CEMETERY (Section 36)

This cemetery is on Rte. 9 at the eastern edge of Bloomington, at the corner of Rte. 9 and Airport Rd.

HOLY CROSS CEMETERY (Section 29)

This cemetery is on West College Ave. in Normal. From the square in Bloomington, take Main St. north to the College Ave. intersection; turn left (W) and continue to Cottage Ave. The cemetery is at the College/Cottage corner. Turn left (S) on Cottage and find the entrance to your right (W).

| | | | | | |
|------------|-------------|-------------|-------------|------------|-------------|
| | | GRIDLEY | HEWES | YATES | |
| | WHITE OAK | HUDSON | MONET CREEK | LEXINGTON | JAWN-DALE |
| WINTER | DRY GROVE | NORMAL | TOMANDA | BLUE MOUND | MARTIN |
| ALLIN | DALE | BLOOMINGTON | OLD TOWN | JANSON | ARMON SMITH |
| MOUNT HOPE | PUNKS GROVE | RAN-DOLPH | DOWNES | WHITE | WEST |
| | | | | | PELL-LOWER |

NORMAL

T. 24 N. - R. 2 E.

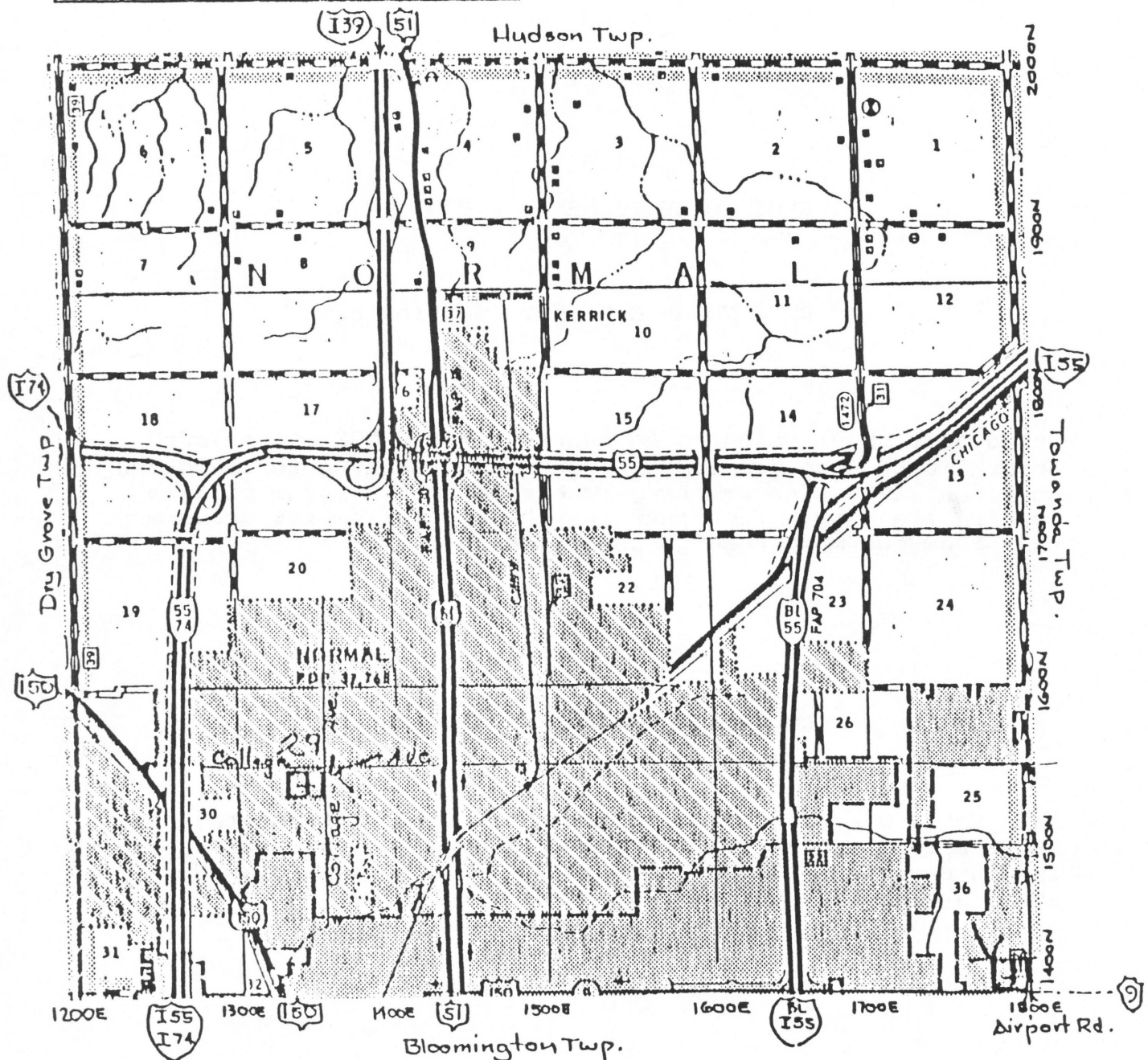

BLUE MOUND TOWNSHIP 1.24N - R.4E

BLUE MOUND CEMETERY (Section 27)

Drive east of Bloomington on Route 9. At 2700E, turn left (north) and watch for 1500N. Turn right (east) onto 1500N and continue east. The cemetery is marked by two large pillars bearing its name. Turn left (north) and follow the drive way back from the main road to the cemetery.

HOLY CROSS CEMETERY (Section 19)

Take Route 9 east of Bloomington, IL. Turn left (north) on 2400E and continue north for about 2 miles. The cemetery is at the intersection of 2400E and 1600N. The community of Merna is about a mile to the west of the cemetery site.

McLEAN COUNTY ILLINOIS

| | | | | | | |
|------------|-------------|-------------|-------------|------------|-------------|--------------|
| | | | GRIDLEY | CHENOA | YATES | |
| | | HUDSON | MONEY CREEK | LEXINGTON | LAWDALE | CROFTSEY |
| WINTER | DRY GROVE | FORMAL | TOWANDA | BLUE MOUND | MARTIN | ANCHOR |
| ALLIN | DALE | BLOOMINGTON | OLD TOWN | DAWSON | ARROW SHITH | CHENEY GROVE |
| MOUNT HORN | PUNKS GROVE | RANDOLPH | DOWNS | EMPIRE | WEST | PELL-LONER |

BLUE MOUND

T.24 N. - R.4 E.

Lexington Twp.

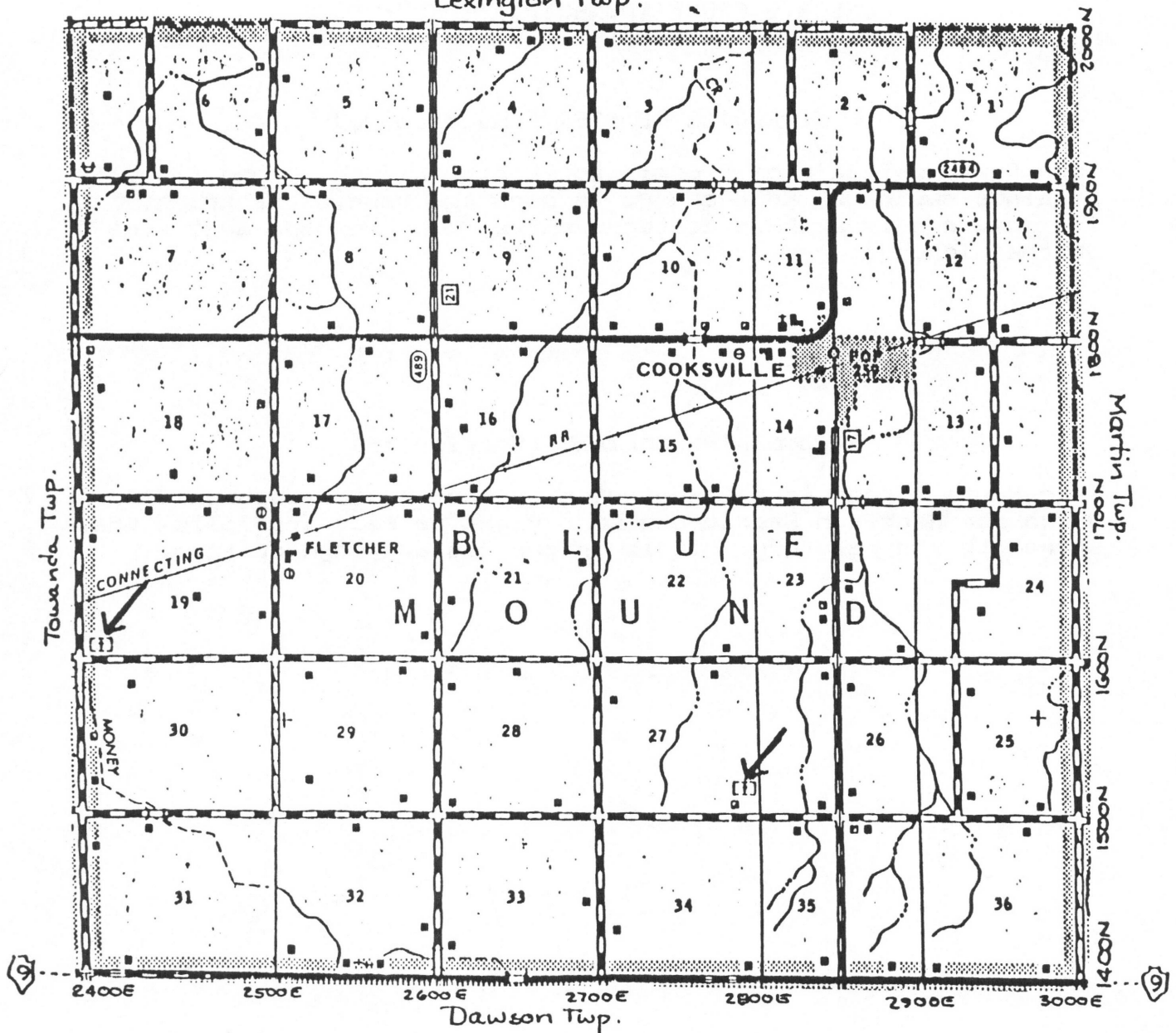

CHENEYS GROVE TOWNSHIP T.23N - R.6E

RIVERSIDE CEMETERY (Section 28)

Take Route 9 East from Bloomington to the Saybrook road (3850E). Continue south on 3850E and go through the town of Saybrook. The cemetery is a short distance out of town, on the west side of the highway.

TOWNSHIP CEMETERY (Section 28)

Take Route 9 East from Bloomington to the town of Saybrook. Watch for Harrison Street and turn right or West and follow the street to the cemetery. It is on the western edge of town.

| | | | | | | |
|----------|--------|--------|--------|--------|--------|--|
| | | | GRADY | CHENOA | TATES | |
| | JUDSON | MONEY | LEE- | JAWN- | | |
| | CRK | CREEK | INGTON | DALL | PROSEY | |
| DIAMETER | DRY | NORMAL | TOMAND | WATIN | ANCHOR | |
| | DROVE | | BLUE | | | |
| | | | MOUND | | | |
| ALLIN | DALL | BLOOM- | OLD | JANSON | ILHEI | |
| | | INGTON | TOWN | BRISH | DOVE | |
| | | | | | | |
| MOUNT | PINKS | PAH- | DOWN | EMPIRE | PELL- | |
| HOIS | DOVE | DOLIN | | WEST | LOHER | |

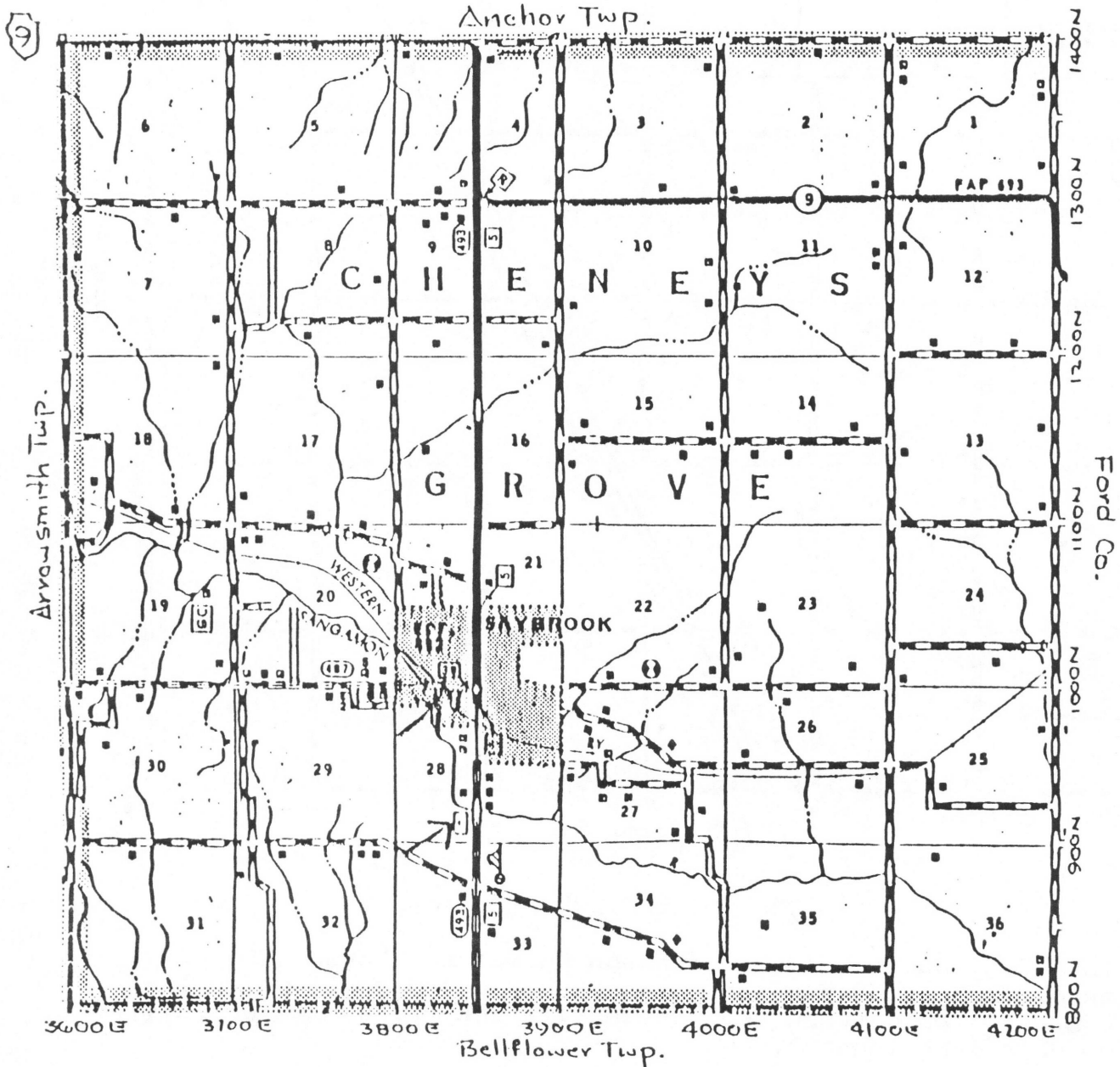

McLEAN COUNTY ILLINOIS

CHENOA

T. 26 N. - R. 4 E.

Livingston Co.

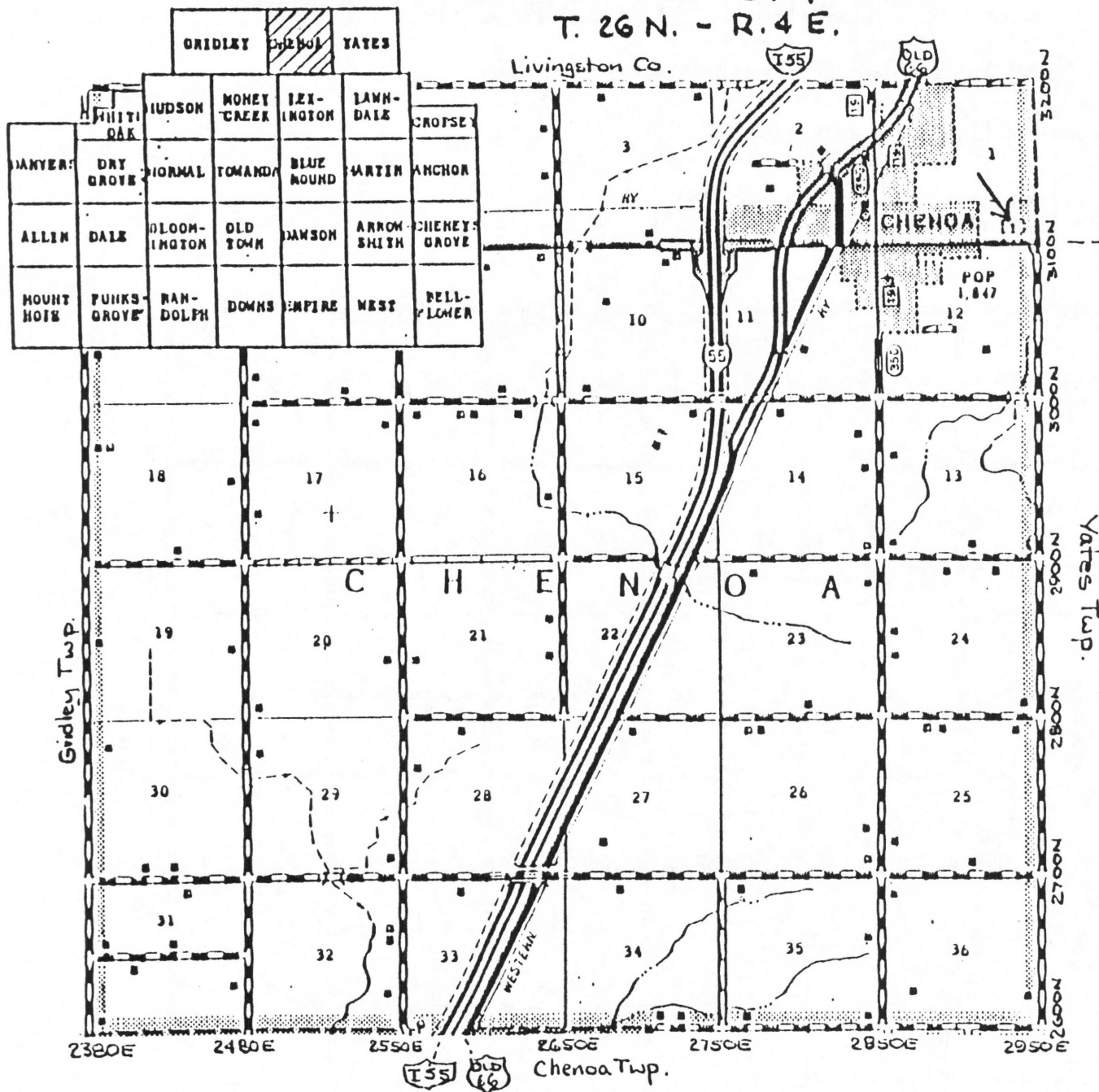

CHENOA CEMETERY (Section 1)

Take I-55 north from Bloomington-Normal to Chenoa, IL. Exit onto US 24 at Chenoa, turn right (east) and continue on that route to the eastern edge of the village. The cemetery will be on your left (north).

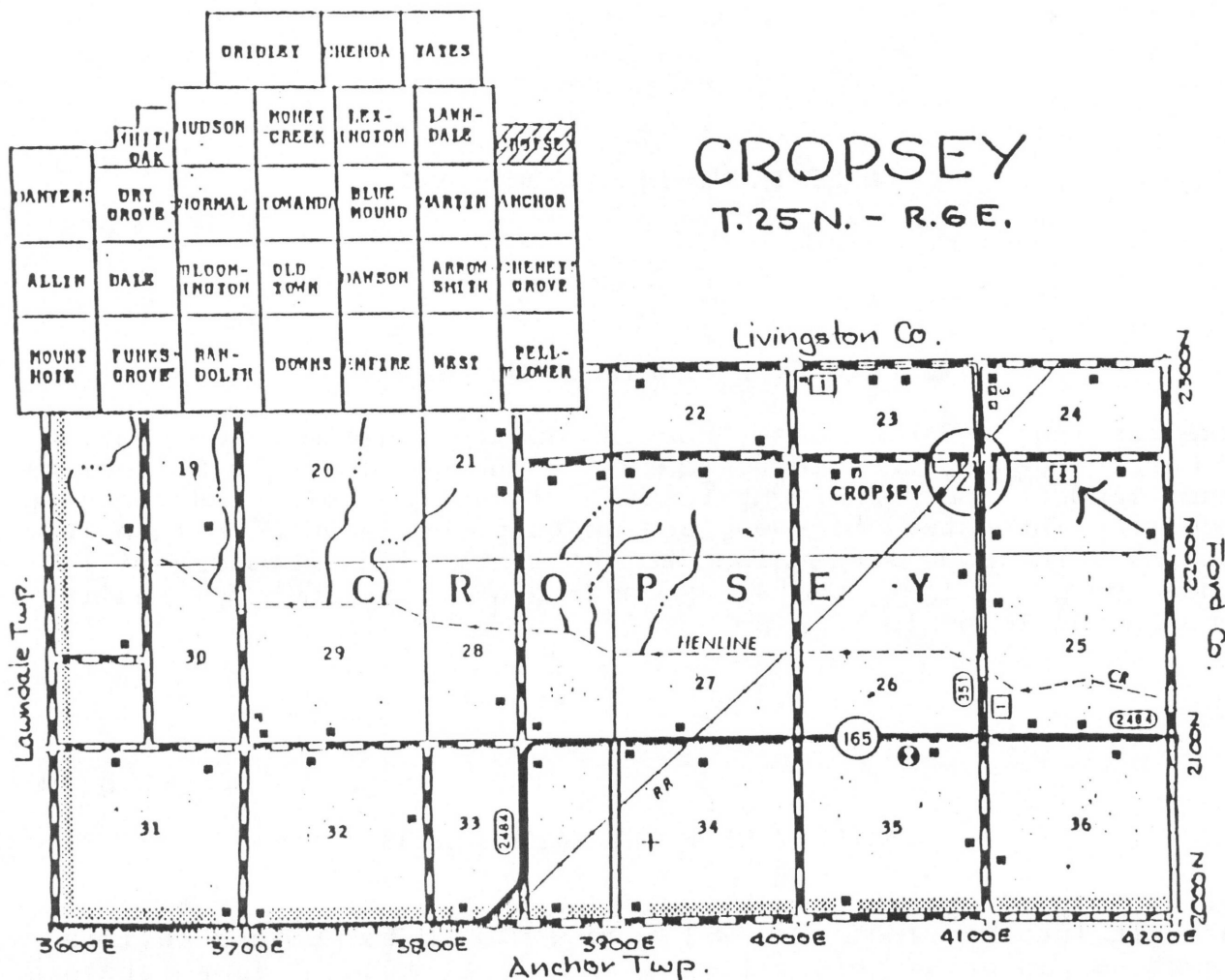

CROPSEY CEMETERY (Section 24)

Drive east on Route 9 from Bloomington to 2300E (Route 165). Turn left (north) and follow Route 165 through Cooksville, Colfax and Anchor. After leaving Anchor, watch for 4100E. Turn left (north) to Cropsey. At Cropsey, turn right (east) on 2250N and, a short distance out of town, the cemetery can be seen on the right (south).

DALE TOWNSHIP T.23N - R.1W

SCOGIN HILL CEMETERY (Section 13)

Take Washington Street west from the downtown Bloomington square. At Morris Avenue, turn left (south). Continue south to Six Points Road (1200N) and turn right (west). Travel on this road, passing under the interstate highway, and on to county road 26. Turn left (south). The road winds along to the south. The cemetery will appear on your right (west). A portion of this cemetery lies in Bloomington Township Section 18.

SHIRLEY CEMETERY (Section 35)

Follow I-55 southwest from Bloomington to the Shirley exit. Take the exit into Shirley. You will cross Old Route 66 and railroad tracks as you enter this village. Turn left (south) immediately after crossing the tracks. Drive beyond the grain elevator storage area and park on the south side of the buildings. You can walk to the cemetery on a grassed driveway along the tracks.

DALE
T. 23 N. - R. 1 E.



DANVERS TOWNSHIP T.24-25N - R.1W

IMHOFF CEMETERY (Section 27)

Take I-74 west from Bloomington to Carlock, exit onto 2050N and travel west to intersection with 350E. Turn right (north) and continue on this road, past 2100N until you see the cemetery on your left (west). It is close to the Woodford County line.

MENNONITE CEMETERY (Section 1)

From Bloomington, take Route 9 west and north to Danvers. As Route 9 turns left (west), you will continue north INTO Danvers and follow the road on north and out of town. This route will curve right (east) and intersect with 500E. Turn left (north) and follow 500E to 1950N. Turn right (east) and the North Danvers Mennonite Church and cemetery will appear on the right (south) side of the road. It is well identified by signs.

PARK LAWN CEMETERY (Section 13)

Take Route 9 west and north from Bloomington into Danvers. Turn right (east) at East North Street. The cemetery will be found at the intersection with North State Street. The cemetery gates are on the northeast corner of this intersection. A school is also nearby.

STOUTS GROVE CEMETERY (Section 16)

From Bloomington, take Route 9 west and north to Danvers. Continue north into the village of Danvers and to the first stop street (Exchange Street) and turn left (west). Travel three blocks and turn right (north), go one block and turn left (west). Follow this road. You will pass one road which goes to your right while your route gently winds along. BE ALERT for 275E on your left (south). YOUR TURN will come just beyond this junction, where you will turn right (north) and find the cemetery on your right (east).

WEST UNION CEMETERY (Section 19)

Take Route 9 west out of Bloomington. Follow the route to near the Tazewell County line. The cemetery is on the right (north) side of the highway shortly BEFORE 50E. This cemetery is easy to find, just follow Route 9.

Woodford Co.

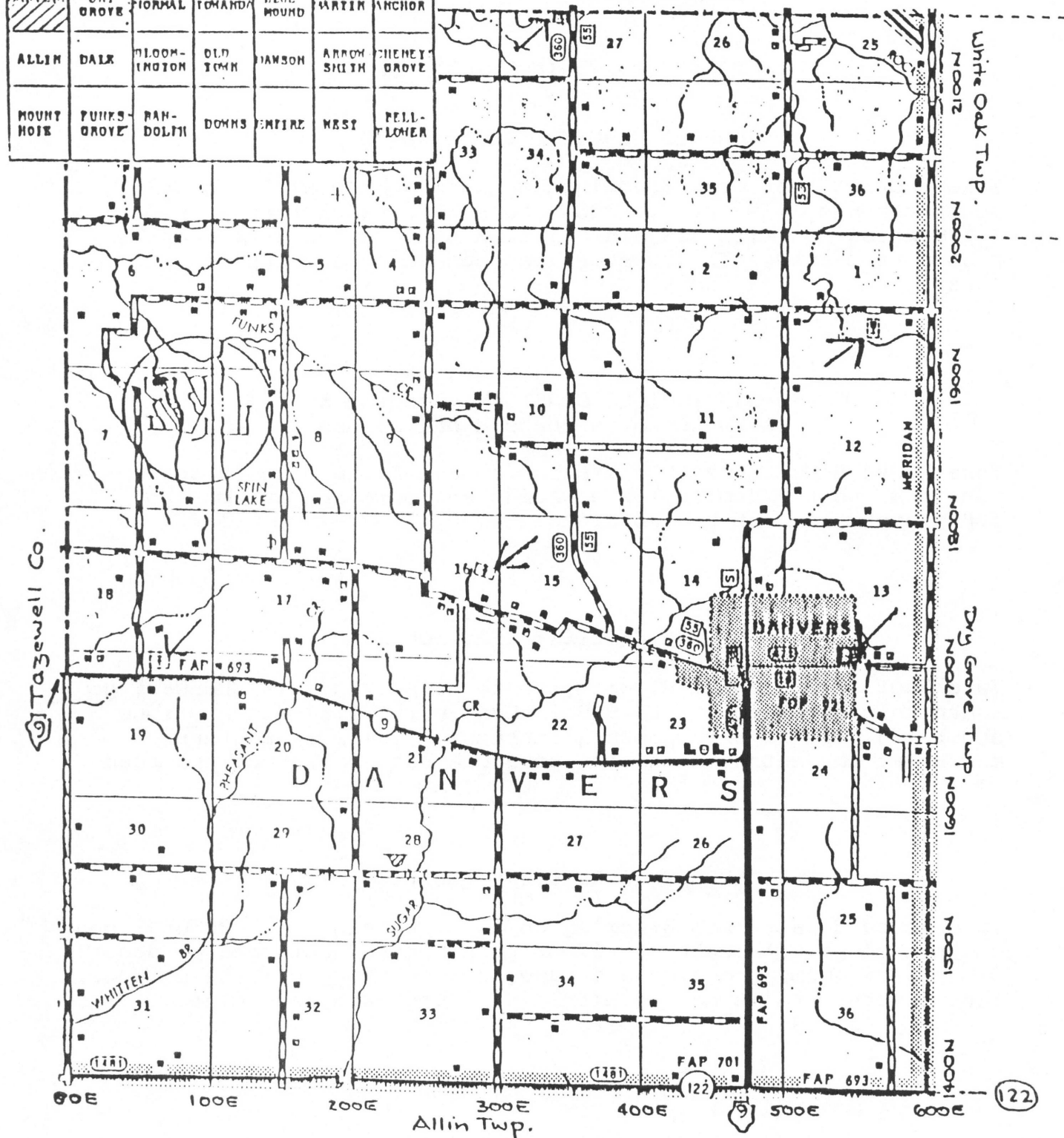

DAWSON TOWNSHIP T.23N - R.4E

BARNES CEMETERY (Section 36)

Take Route 9 East from Bloomington to Ellsworth exit (2850E); go south through Ellsworth to 850N; turn left (east) and in about 1 1/4 miles you will see a small sign post on the left (north) side of the road. The cemetery is reached by driving on a short lane.

BENJAMINVILLE CEMETERY (Section 6)
(Also known as Bentown or Friends)

Take Route 9 East from Bloomington to 2400E; turn south and continue about 3/4 mile. The church and cemetery are on the left (east) side of the road.

DAWSON CEMETERY (Section 26)

Take Route 9 East from Bloomington to Ellsworth exit (2850E); go south through Ellsworth to 975N; turn left (east) and continue about 1/4 mile to the cemetery entrance. There is a stone marker at the entrance and the cemetery sits back from the road.

FRANKEBERGER CEMETERY (Section 27)

Take Route 9 East from Bloomington to Ellsworth exit (2850E); go south through Ellsworth, to 975N; turn right (west) and go about 3/4 mile. After crossing a bridge, the cemetery will be on your left (south) and is marked with a sign post and name plate.

| | | GRIDLEY | HEHOB | YATES | |
|--------|------------|--------------|-------------|------------|-----------------|
| | HUDSON | MONEY CREEK | J.E. INGTON | DAW-DALE | ROOSE |
| LANIER | DRY GROVE | NORMAL | ICOMAND | BLUE MOUND | GREEN ANCHOR |
| ALLIN | DALE | BLOOM-INGTON | OLD TOWN | DAWSON | GREEN GROVE |
| MOORE | FUNK GROVE | RAN-DOLPH | DOHNS | EMPIRE | WEST BELL-LOVER |

DAWSON

T. 23 N. - R. 3 E.

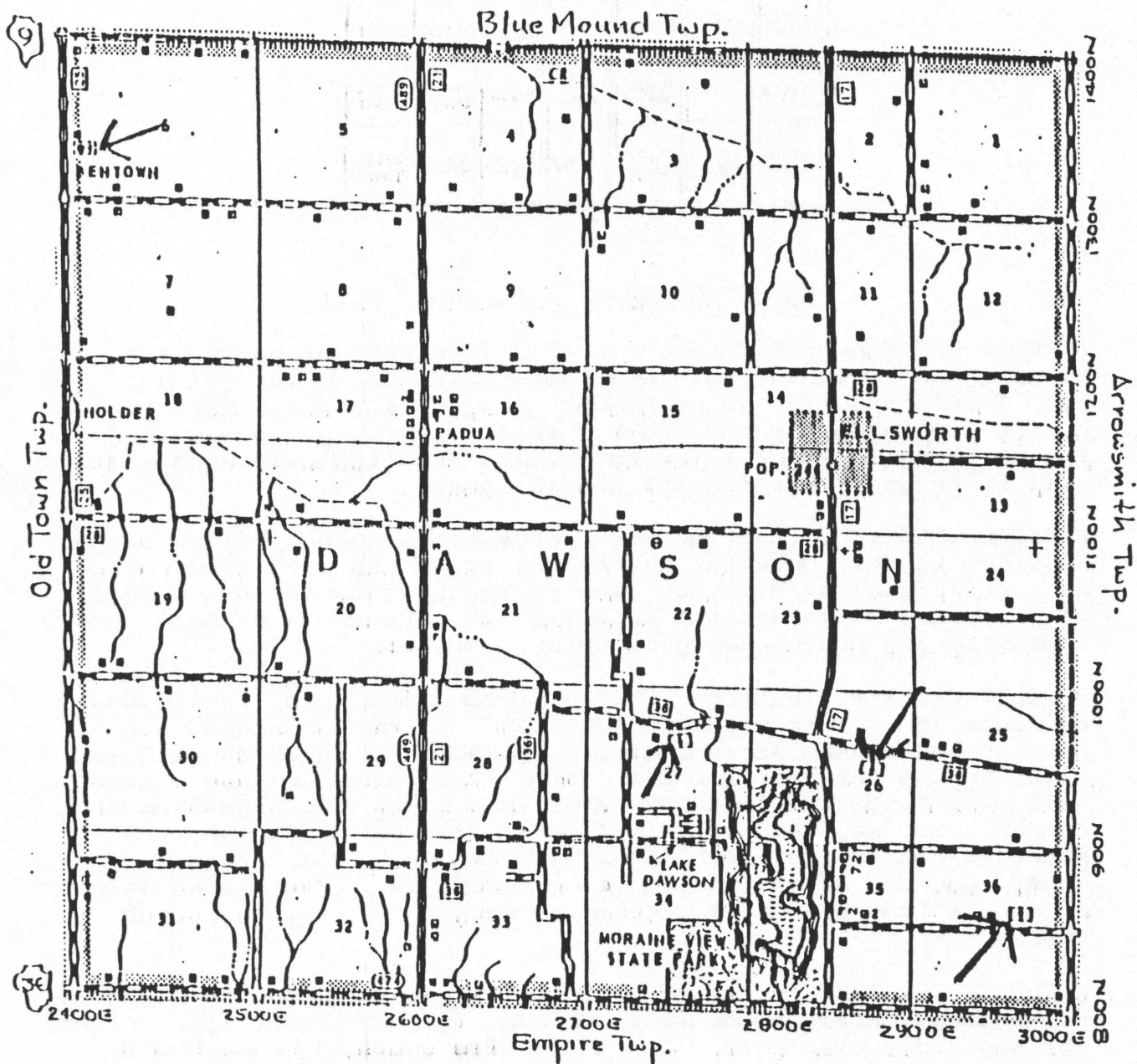

| McLEAN COUNTY ILLINOIS | | | | | | |
|------------------------|-------------|-------------|----------|-------------|-------------|--------------|
| | | | GRIDLEY | CHENOA | YATES | |
| | | | HUDSON | MONEY CREEK | LEXINGTON | LAWN-DALE |
| | WHITE OAK | | | | | CROFSEY |
| DANVERS | DRY GROVE | NORMAL | TOWANDA | BLUE MOUND | MARTIN | ANCHOR |
| ALLIN | DALE | BLOOMINGTON | OLD TOWN | DAWSON | ARROW SMITH | CHENEY GROVE |
| MOUNT HOIS | PUKES GROVE | RAH-DOLPH | DOWN | EMPIRE | WEST | BELL-FLORA |

DOWN TOWNSHIP T.21-22N - R.3E

DIAMOND GROVE CEMETERY (Section 7). Take Rte. 51 South from Bloomington to I-74 East. Use Downs exit and, after exiting from Interstate 74, go southwest, away from Downs. The road curves gently and becomes 700N. You'll now be going west and the cemetery is about 1 1/2 to 2 miles from the exit area. It will be on your left (south) and is marked. .

HOPEWELL CEMETERY (Section 4). From Bloomington, follow either Rte. 150 to the southeast or Rte. 51 south and I-74 toward the east until you reach Downs. The cemetery is on the north edge of town on a hill adjacent to Route 150. Downs is a small community and the cemetery is easily located.

PEASLEY CEMETERY (Section 20). Go from Bloomington toward Downs on Route 150. Turn right (S) at 1900E. This corner has a gas station and tavern as landmarks. Continue on 1900E about 5 1/2 miles to the intersection with 400N. Turn left (E) and a corn crib will be on the left (N). This is a short distance from the corner. You may leave the road and drive the grass lane in front of and to the east side of the building. If it isn't muddy, you can drive (slowly) to the cemetery. This also is a 15 minute (one-way) walk to the cemetery in a small grove of trees.

RUTLEDGE CEMETERY (Section 23). Go from Bloomington to Downs. From Downs, continue southeast on Rte. 150 to 2200E. Turn right (S) and cross over I-74. About one mile south, the road will jog left and then right (S) again. The cemetery is at the junction with 400N.

Old Town Twp.



DRY GROVE TOWNSHIP T.24N - R.1E

EAST TWIN GROVE CEMETERY (Section 35)

Take Route 9 west from Bloomington. The cemetery is about one mile west of the Diamond Star Parkway (Route 150) stoplight. Watch for it on your right (north) at 1000E.

GILSTON CEMETERY (Section 29)

Take Route 9 west from Bloomington to 750E. Turn right (north) and, when you reach a "T" crossing, turn right (east) and go 1/10 of a mile. The cemetery lies on your right (south) and is accessed by a grassed lane. You can see the stones from the road.

HALL-BARNARD CEMETERY (Section 29)

Take route 9 west from Bloomington. Turn right (north) on 750E. Follow road to the "T" and turn to your left (northwest). A short distance along this road brings you to an intersection with 700E. An electric power sub-station will be on your left. Turn left (south) and drive past the power station. The cemetery will be on your left (east) and is marked with a wooden sign.

LANTZ CEMETERY (Section 4)

Take Route 150 northwest from Bloomington. Turn left (west) on 1950N. Continue west, past 900E and cross the railroad tracks. The cemetery will appear on your right (north).

ROSEWOOD CEMETERY (Section 33)

Travel on Route 9 west from Bloomington to 810E. This is a busy highway and this intersection may "fly by"; so watch closely. Turn right (north) and the West Union Christian Church will be on your right (east). Road 1425N leads off to the left (west) just across from the church. The cemetery is on the north side of the church and is identified with a sign.

WILSON CEMETERY (Section 20)

Follow the route as given above for Hall-Barnard Cemetery. When you reach the power sub-station, turn right (north) and cross 1610N. WATCH CLOSELY for a right (east) turn, which will become 1625N. The cemetery will be found 7/10 of a mile away. It is on your left (north). Follow the fence line, on a grassed lane north to the tree (hedge) line, where you will find the cemetery.

| | | | | | | |
|------------|-------------|-------------|-------------|------------|-------------|-------------|
| | | | GRIDLEY | MEHOLA | YATES | |
| | WHITE OAK | HUDSON | MONEY CREEK | LEXINGTON | LAMM-DALE | PROFSE |
| DANVERS | DRY GROVE | NORMAL | LOMANDA | BLUE MOUND | MARTIN | ANCHOR |
| ALLIN | DALE | BLOOMINGTON | OLD TOWN | JAMSON | ARROW SHOOT | MEHEE GROVE |
| MOUNT HOPE | PUNKS GROVE | HAN-DOLPH | DOMMS | EMPIRE | WEST | PELL-LOMER |

DRY GROVE

T.24-N. - R.1E.

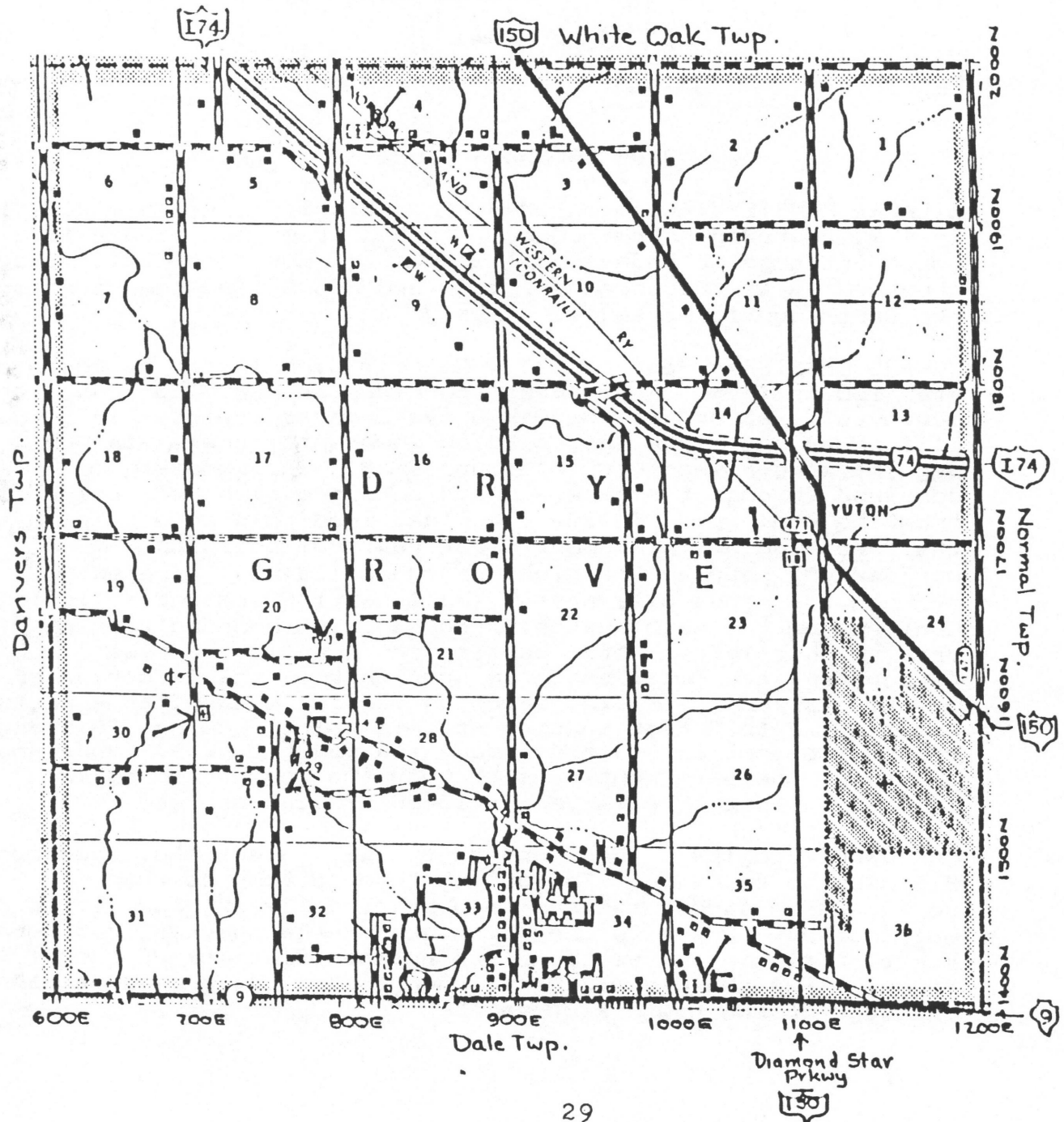

McLEAN COUNTY ILLINOIS

| | | | | | | |
|---------------|-----------------|------------------|-------------|----------------|----------------|------------------|
| | | | BRIDLEY | CHENOA | YATES | |
| | | WHITE DALE | JUDSON | MONEY CREEK | LEE- INGTON | LAWN- DALE |
| | | | | | | CROPSY |
| WINTER | DRY GROVE | NORMAL | TOWANDA | BLUE MOUND | MARTIN | ANCHOR |
| ALLIN | DALE | BLOOM- INGTON | OLD TOWN | DANSON | ARROW SMITH | CHENEY- GROVE |
| MOUNT HOPE | PUNKS- GROVE | RAN- DOLPH | DOWNB | EMPIRE | WEST | BELL- FLOWER |

EMPIRE TOWNSHIP T.21-22N - R.4E

GILMORE CEMETERY (Section 30). From Bloomington, take Rte. 150 or I-74 to LeRoy. From LeRoy, proceed from town across I-74 at southeast edge of town. Follow 400N to your right (N). The cemetery is at the corner of 400N and 2450E. The cemetery is on the south and is marked with a sign.

HOWARD CEMETERY (Section 27). Go from Bloomington to LeRoy on Rte. 150 or I-74. From LeRoy, continue on Rte. 150 toward the southeast. After passing Oak Grove Cemetery on your left, you will cross the creek and, also on your left, there will be a sign marking Howard Virgin Timber Park. The cemetery is accessed through the park. Drive to a graveled area downhill from the shelters. Follow the wide, wood-chip covered path to the left side of the cement block restroom building. (Don't be confused by path to the right of the building.) The path through the woods will pass a small seating area of split logs. Continue on the path, watching for a large mounded area near a tree to your left. After passing the tree, a narrower (secondary) path will angle to your left in the direction of the creek. Follow this path, watching for two wooden fence posts about 2 1/2 to 3 feet apart. At this point, you can look across the ravine (not across the creek) and see the gate, fence and cemetery. The path continues through the ravine and to the cemetery. Walking time, about 15-20 minutes one way.

OAK GROVE CEMETERY (Sections 22 and 27). Take Rte. 150 from Bloomington to LeRoy. Follow 150 through town to the southeastern edge. The cemetery entrance is on your left and well marked. Drive to the north end of the cemetery and turn right. (This is the section line between Sections 22 and 27.) You will see the old Oak Grove on your left as you drive along the edge of the new Oak Grove.

Dawson Twp.



FUNKS GROVE TOWNSHIP T.21-22N - R.1E

McLEAN COUNTY ILLINOIS

| | | | | | | |
|------------|-------------|-------------|-------------|------------|-------------|--------------|
| | | GRIDLEY | CHENOA | YATES | | |
| | | HUDSON | MONEY CREEK | LEXINGTON | LAWNDALE | CROPSEY |
| | WHITE OAK | | | | | |
| WINTER | DRY GROVE | NORMAL | TOMANDA | BLUE MOUND | MARTIN | ANCHOR |
| ALLIN | DALE | BLOOMINGTON | OLD TOWN | JANSON | ARROW SMITH | CHENEY GROVE |
| MOUNT HOPE | FUNKS GROVE | RANDOLPH | DOWNES | EMPIRE | WEST | PELLFLOWER |

BROCK CEMETERY (Section 30)

The easiest route to this cemetery seems to be: Leave Bloomington on I-55 going southwest toward Springfield. Exit at McLean and take Route 136 left (east) under the interstate. Continue on Route 136 (200N) to 675E. Turn left (north) for one mile; jog to the right and then left (north) on 685E. Cemetery will appear on your right (east).

FREMONT CEMETERY (Section 10)

Travel Route 51 south from Bloomington. Turn right (west) at Heyworth onto Route 136 (200N) and continue on to 950E. Turn left (south) and, at 50N, turn right (west). The cemetery will be on your left (south) at the end of a graveled lane, just a short way from the corner.

FUNKS GROVE CEMETERY (Sections 17 and 18)

Take I-55 from Bloomington toward the southwest. Exit at Shirley to the right (west) and, at Old Route 66, turn left (south). DO NOT GO INTO the village of Shirley. Continue on Old 66 to Funks Grove. Turn right (west) onto 550N. This road will curve to the left (south) and be intersected on the right by the road to the cemetery. Turn right to reach the cemetery entrance.

FUNKS GROVE

T. 21-22N. - R. 1E.

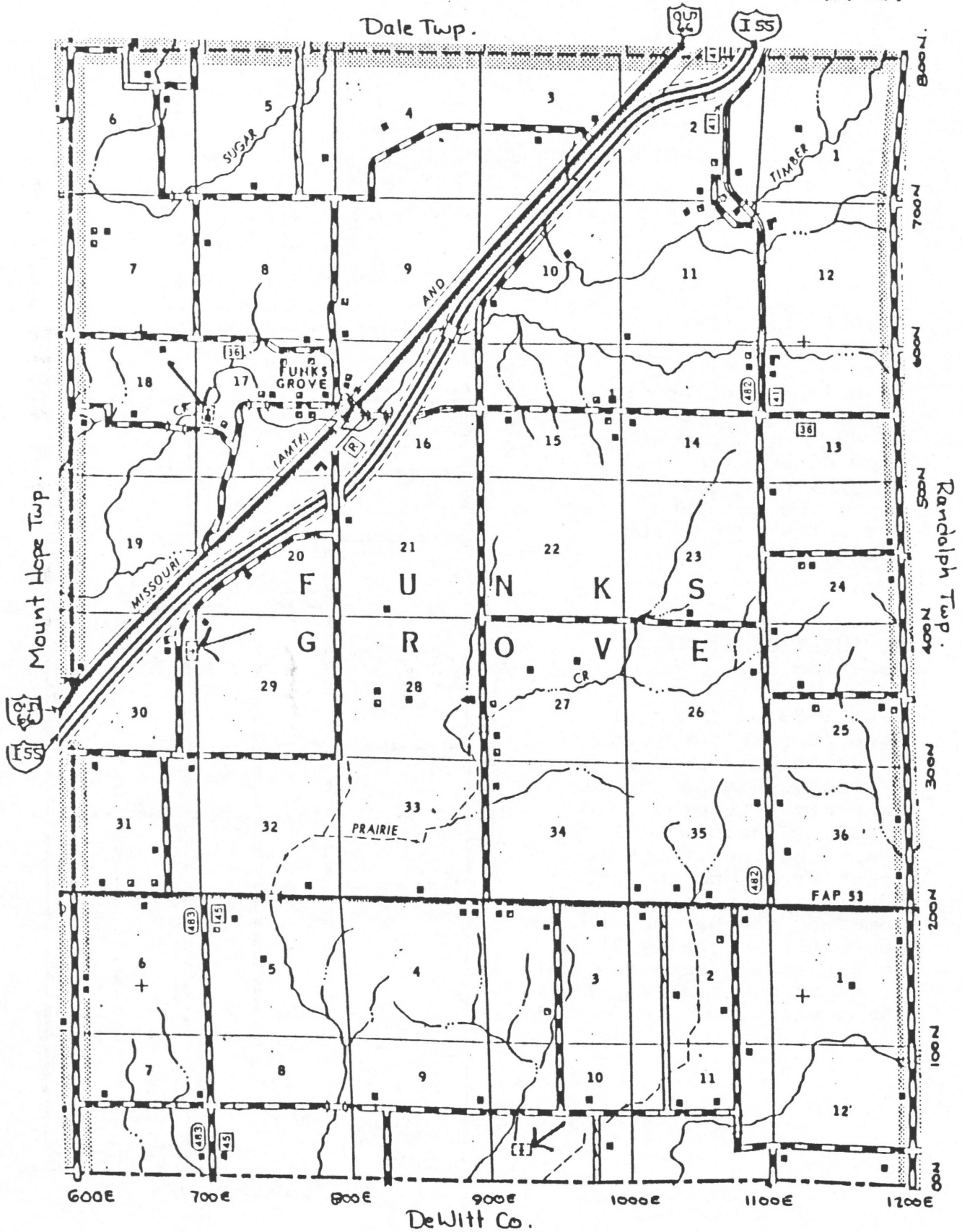

GRIDLEY TOWNSHIP T.26N. - R.2 & 3E

GRIDLEY
T.26N. - R.2E.
Woodford Co.

GRIDLEY CEMETERY
(Section 4)

Take I-39 north to El Paso, turn right (east) on US 24. At the eastern edge of Gridley, turn left (north) on 2080E (Route 67). The cemetery is at the intersection with 3200N.

McNAUGHT CEMETERY
(Section 27)

Take I-39 north to El Paso, turn right (east) on US 24 to Gridley and, at the eastern edge of town, turn right (south) onto 2080E. Continue to 2775N where the road turns left (east). As you approach the next turn, the cemetery can be seen to your left (north). It is back from the road and can be reached by walking from the corner.

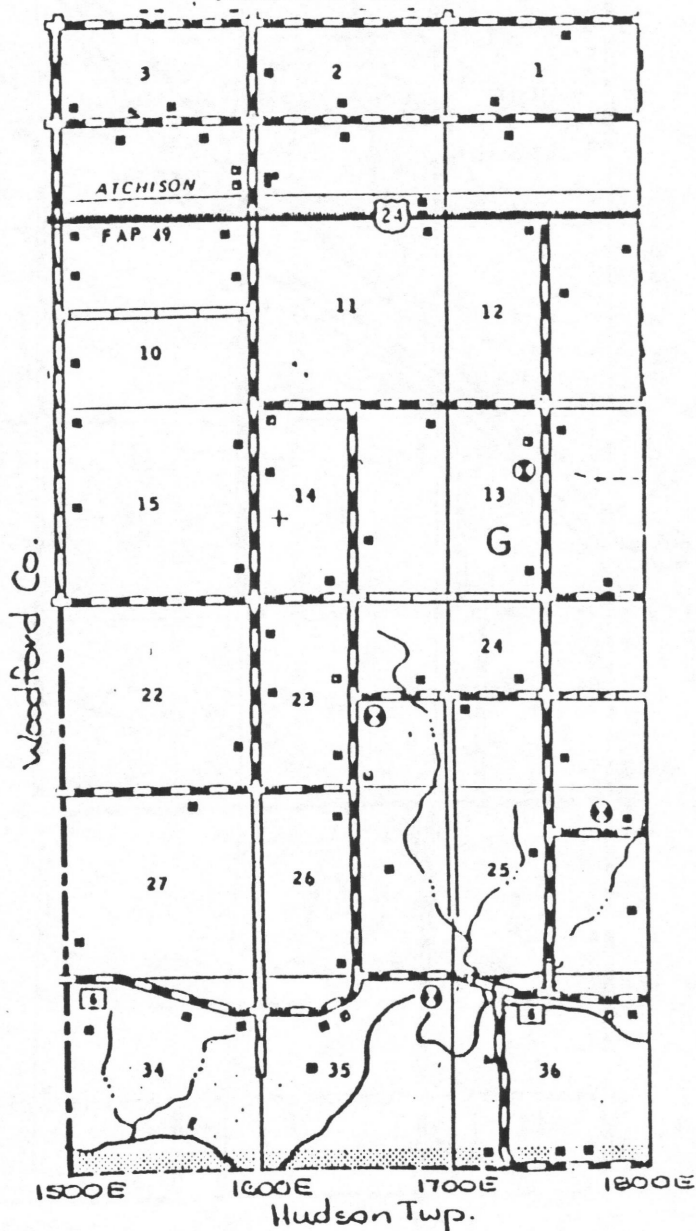

| | | | | | |
|------------|-------------|--------------|-------------|------------|-------------|
| | | GRIDLEY | CHENOA | YATES | |
| | FRUIT OAK | JUDSON | MONEY CREEK | IRK-INGTON | LAWN-DALE |
| DANVER | DRY GROVE | NORMAL | TOWANDA | BLUE MOUND | MARTIN |
| ALLIN | DALE | BLOOM-INGTON | OLD TOWN | JANSON | ARROW-SMITH |
| MOUNT HOIS | PINKS-GROVE | RAH-DOLPH | DOWNS | EMPIRE | WEST |
| | | | | | PELL-FLOWER |

GRIDLEY

T.26 N.- R.3 E.

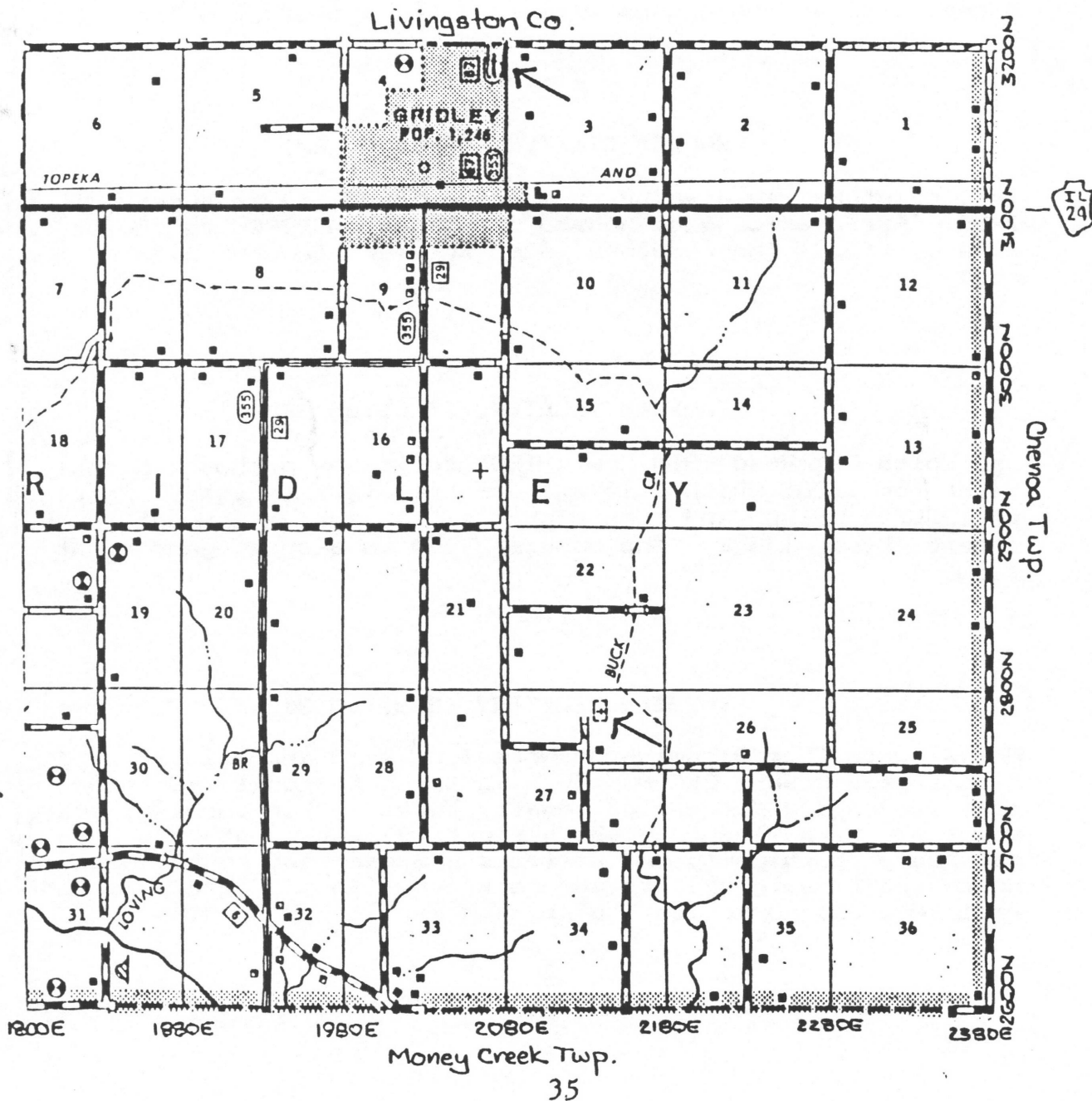

HUDSON TOWNSHIP T.25N - R.2E

HAVENS CEMETERY (Section 28)

Drive north of Bloomington-Normal on I-39. Exit at Hudson. Turn right (east). The cemetery will be at your right (south). A road between the houses will lead you back to the location.

HUDSON CEMETERY (Section 22)

This cemetery may also be reached by traveling to Hudson, IL on I-39. After exiting at Hudson, continue on 2200N to the eastern edge of town. The cemetery is on the left (north) side of the road.

KAUFMAN CEMETERY (Section 32)

Use White Oak Road (Old Route 150) to leave northwest Normal. Watch for 1200E which will exit to the right (north). Continue on 1200E to 2100N and turn right (east). Drive through the next intersection, 1300E. The cemetery can be seen at your right (south).

MESSER CEMETERY (Section 3)

Drive north from Bloomington-Normal on I-39 and exit at Lake Bloomington Road - 2500N. Turn left (north) on 1475E and continue to the first right (east) turn. After turning, travel about 3/4 of a mile to a sharp right (S) turn. At this turn you may leave the highway and follow a grassed lane to the east, north and finally east to the cemetery. This cemetery is not visible until you drive the grassed lane.

| | | | | | | |
|------------|-------------|-------------|-------------|------------|-------------|--------------|
| | | | ORIDLEY | CHEROA | YATES | |
| | | HUDSON | MONEY CREEK | LEXINGTON | LAWNDALE | CROUSE |
| DAVER | DRY GROVE | NORMAL | TOMANDA | BLUE MOUND | MARTIN | ANCHOR |
| ALLIN | DALE | MOON-INGTON | OLD TOWN | JOHNSON | ARROW SMITH | HEENEY GROVE |
| MOUNT HOPE | PUNKS GROVE | RAN-DOLPH | DOWNES | EMPIRE | WEST | PELL-LOWER |

HUDSON

T. 25 N. - R. 2 E.

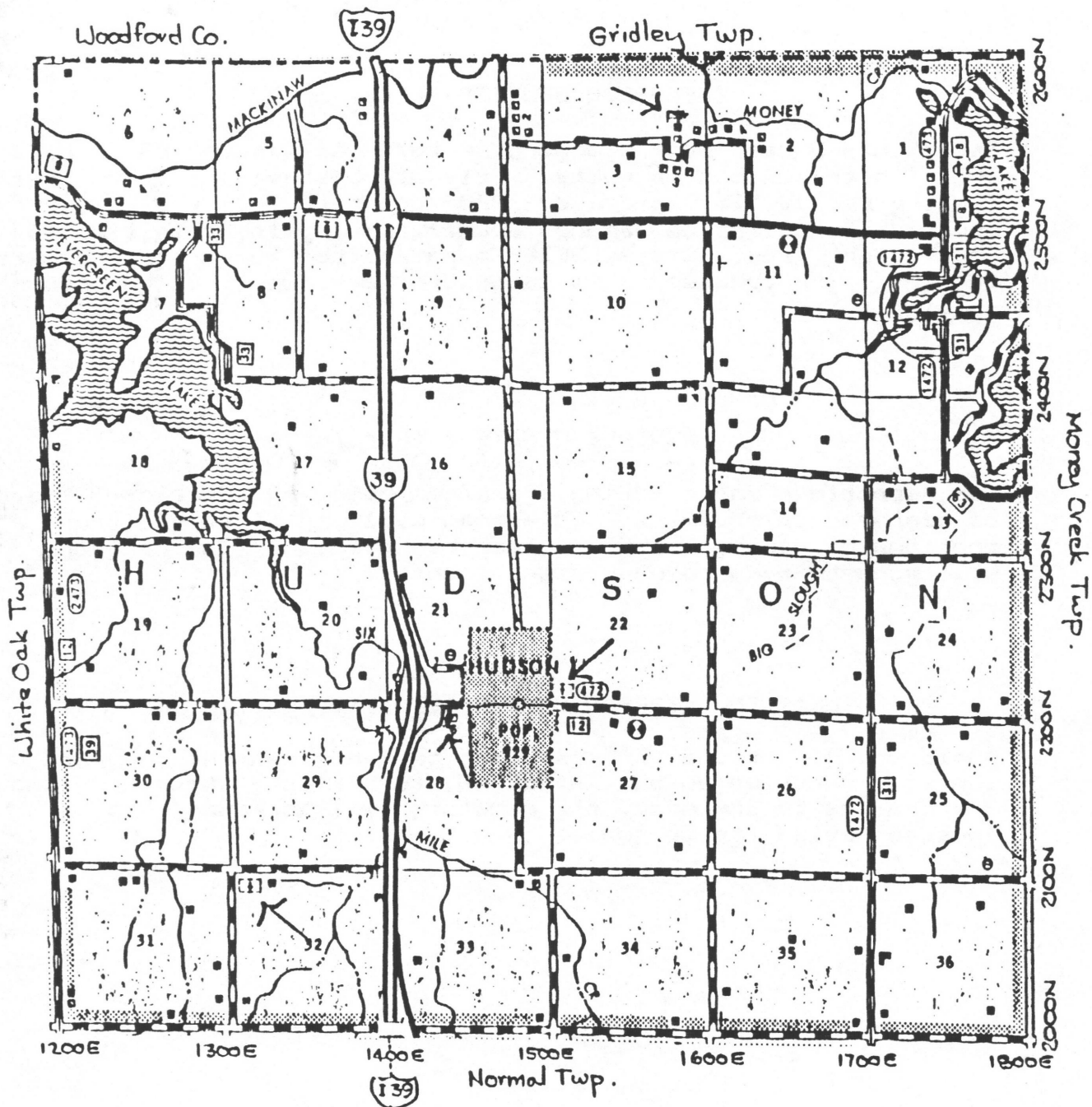

LAWNDALE TOWNSHIP T.25N - R.5E

EVERGREEN CEMETERY (Section 30)

Take Route 9 east from Bloomington to 2300E (Route 165). Make a left (north) onto this route. Drive to Cooksville, IL. After passing Cooksville, watch for 3050E and turn left (north). A short distance further along, you'll turn again, this time to your right (east) and at 3075E make another turn - to the left (north). The cemetery will be on the left (west) as you are driving north.

LAWNDALE CEMETERY (Section 5)

Use directions for reaching Evergreen cemetery (Section 30) and continue north on 3075E. This road will jog right and then continue on north to 2550N. Turn right (east). The cemetery will soon be seen to your right (south).

IMMANUEL LUTHERAN CHURCH CEMETERY (Section 11)

Again use directions for traveling to Evergreen cemetery and continue north on 3075E. At 2450N, turn right (east) and, about 3 1/2 miles to the east, the cemetery will be found. It is located beside the church.

LEXINGTON TOWNSHIP T.25N - R.4E

ADAMS CEMETERY (Section 28)

Take Route 9 east of Bloomington, IL. At 2600E, turn left (north) and, after crossing 2000N, begin watching for a right turn. After turning, the road has several "jogs", then crosses a creek. Just past the creek, the cemetery can be seen at your left (north) and up the hill. You will need to walk along the fence row; there is no gate into the area. May need to be aware of electric fence.

INDIAN FIELD (Section 20)

Use directions for Adams cemetery and stay on 2600E until you reach 2300N. Turn left and, when you next see a right turn (north), you will find a spot at this corner where you can park. Walk straight ahead (west) to the grove of trees. A sign on the northeast corner of this area identifies this cemetery. OVERGROWN.

LEXINGTON CEMETERY (Section 7)

Take I-55 north to Lexington exit. After exiting, turn right and, as you approach town, the cemetery is on your left (north).

PLEASANT HILL CEMETERY (Section 21)

Travel east on Route 9 to 2600E. Turn left (north) and, at 2300N, turn right (east) and continue a short distance to the site, which will be on your right (south).

SCROGIN CEMETERY (Section 7)

Take I-55 north to Lexington. After exiting and driving into Lexington, you will be on Main Street. Watch for Lee Street and make a left (north) turn. At the end of Lee Street, you will see the cemetery just ahead of you on a hill.

WILEY FAMILY CEMETERY (Section 27)

Go east from Bloomington on Route 9. Turn left (north) on 2600E and continue north, watching for the first right turn AFTER passing 2000N. Turn right (east) and, after several jogs, you will pass Adams cemetery. At the intersection with 2800N, turn left (north) and about 3/4 mile further you will be able to see a grove of trees back in a field to your left (west). In 1993, a short lane offered a parking place and then it was a short walk to the site.

| | | | | | | |
|------------|-------------|---------------|-------------|------------|-------------|--------------|
| | | GRIDLEY | CHENOA | YATES | | |
| | | HUDSON | MONEY CREEK | BLUE MOUND | LAWNDALE | CROISE |
| WINTER | DRY GROVE | NORMAL | CHANDLER | BLUE MOUND | MARTIN | ANCHOR |
| ALLEN | DALE | WLOOM-THOMSON | OLD TOWN | WILSON | ARROW SMITH | CHERRY GROVE |
| MOUNT HOPE | PUNKS GROVE | PAN-DOLPH | DOWNS | EMPIRE | WEST | PELL-LONER |

LEXINGTON

T. 25 N. - R. 4 E.

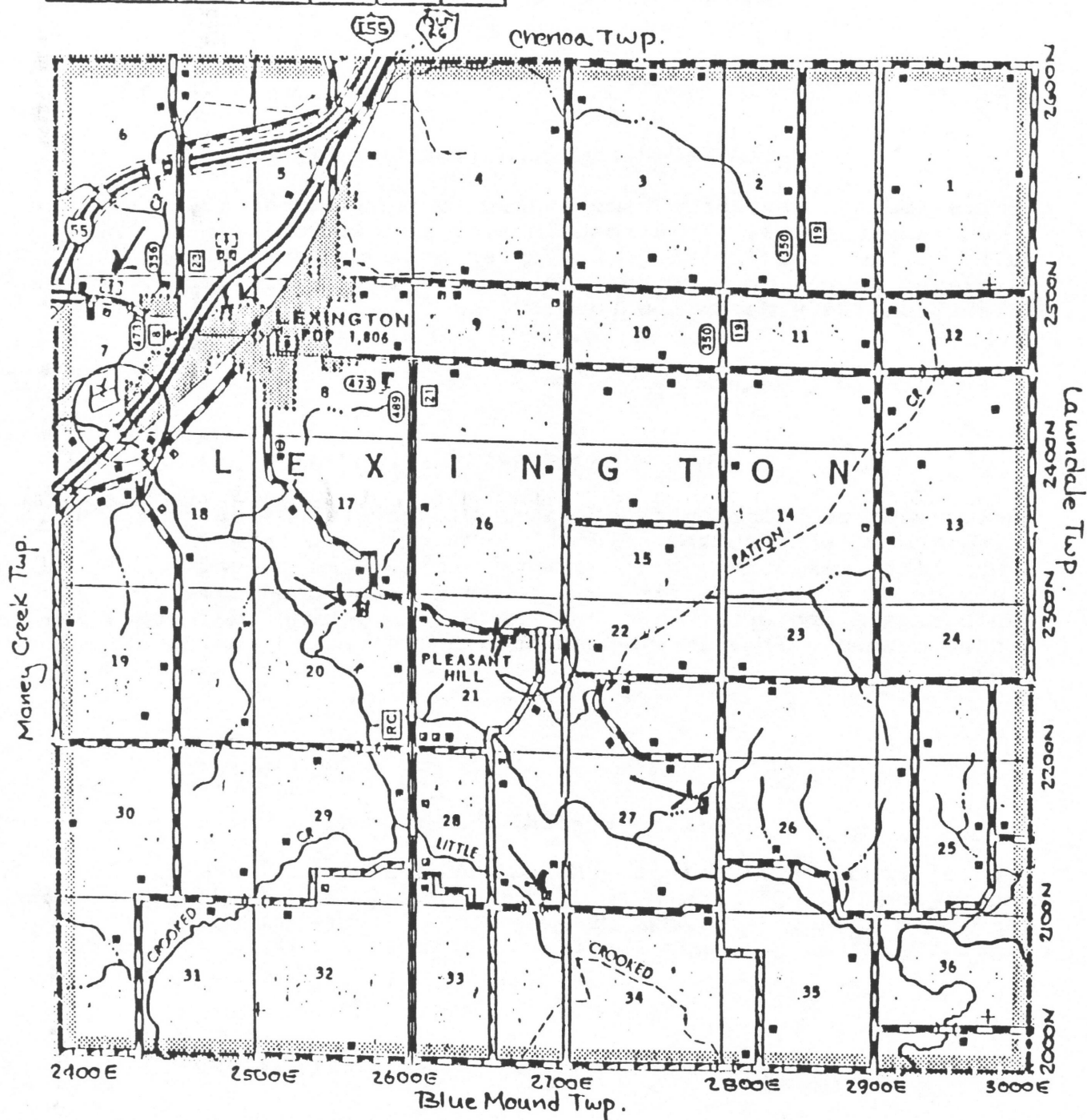

MARTIN TOWNSHIP T.24N. - R.5E

ANTIOCH CEMETERY (Section 1)

Drive Route 9 east from Bloomington to road number 2300E and turn left (north). This road is also marked Route 165. You will follow it to Colfax, IL. After passing through the village, begin watching for the cemetery. It will appear on the right (south) side of the road.

PLYMOUTH CEMETERY (Section 26)

Drive east of Bloomington on Route 9. Several miles from the city, turn left (north) on 3500E. At the next intersection, turn left (west) and, after a short drive, the cemetery will be seen on your right (north). This is an abandoned cemetery. Some stones are upright; others have been placed near trees and under bushes. This is an open area and directly beside the road.

WILEY CEMETERY (Section 4)

Travel from the Bloomington-Normal area east on Route 9. At county road 2300E (Route 165), turn left (north) and follow this route to the western edge of Colfax. Wiley cemetery is on your left (west) as you near the town. This is a well marked site.

McLEAN COUNTY ILLINOIS

| | | | | | | |
|------------|---------------|-------------|-------------|------------|-------------|--------------|
| | | | ORIDERY | CHENOA | TATES | |
| | | HUDSON | MONEY CREEK | LEXINGTON | LAWNDALE | CROFSEY |
| WINTER | DRY GROVE | NORMAL | TOMAHAWK | BLUE MOUND | MARTIN | ANCHOR |
| ALLIN | DALE | BLOOMINGTON | OLD TOWN | DANSON | ARROW SMITH | CHENEY GROVE |
| MOUNT HOIS | PUMPKIN GROVE | RANDOLPH | DOWNES | EMPIRE | WEST | PELL-LOWER |

MARTIN
T.24 N. - R.5 E.

Lawndale Twp.

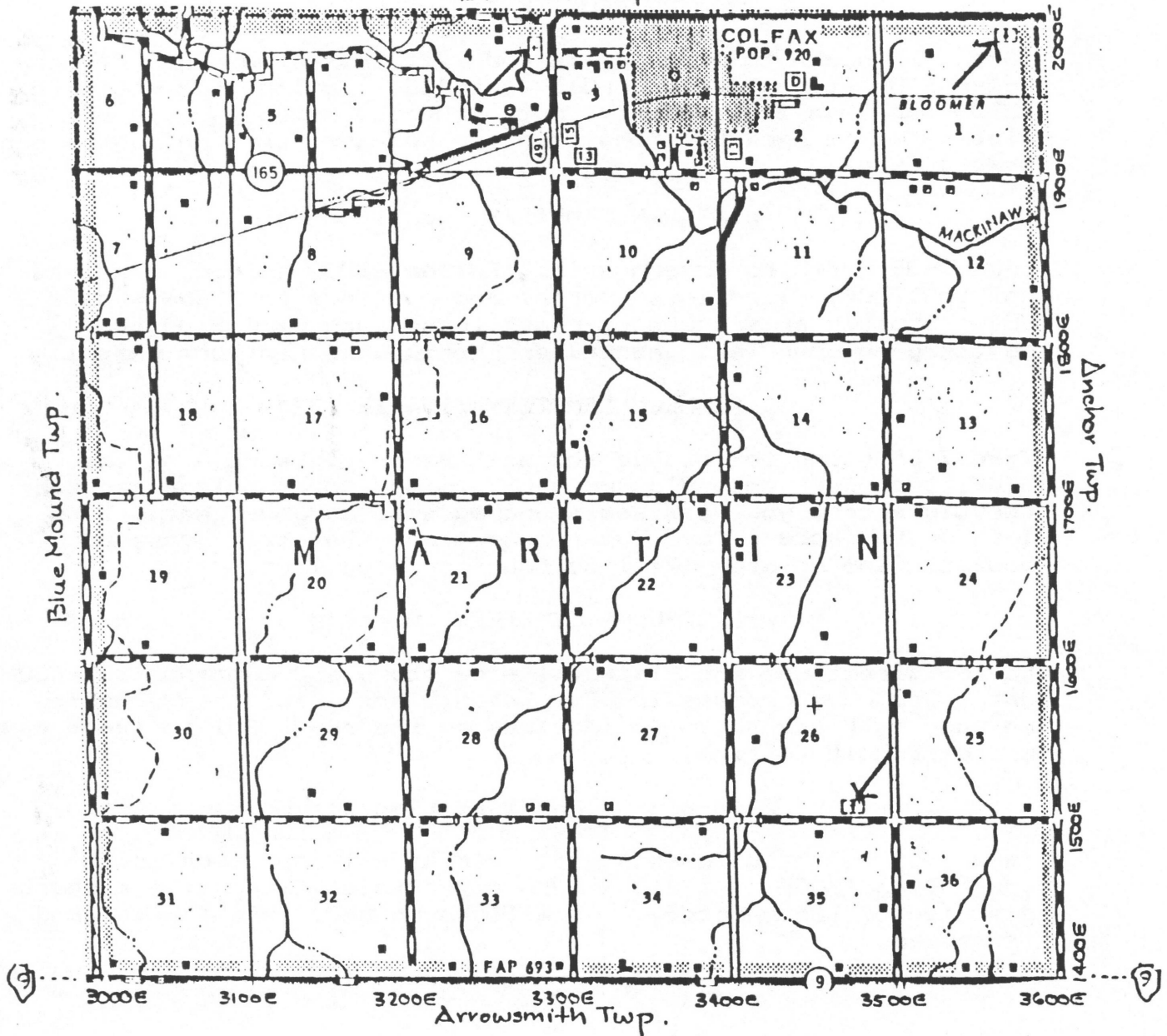

MONEY CREEK TOWNSHIP T.25N - R.3E

CLARKSVILLE CEMETERY (Section 3)

Take I-55 north to the Lexington exit. After exiting, turn left (west) and continue on 2500N. Use the map on the facing page to choose a right (north) turn which will take you to the winding road which runs parallel to 2500N. As you travel along, watch for a grassed lane which follows a fence line back to the cemetery. At this time (January, 1993) there is no sign.

DAWSON CEMETERY (Section 13)

Take I-55 north to Towanda, IL and exit toward Towanda. At the 4-way STOP, turn left onto Old Route 66. Follow this route to 2350N and turn left (west). Watch for the cemetery on your right. It is back from the road and accessed through a gate and over a fence.

HINTHORN CEMETERY (Section 18)

Take I-39 north to Hudson exit. Follow 2200N through town and on, to 1700E. Turn left (north) and continue to 2350N (Route 63). Shortly after turning right (east) you will find the cemetery on your left (north) and behind the Hinthorn Chapel.

PENNELL CEMETERY (Section 33)

Take I-55 north to Towanda and exit toward Towanda. At the STOP, turn left onto Old Route 66. Watch for a bridge and then, shortly after, you will see a wooded area on your left. Turn left on the access road which runs along the small group of houses. The cemetery will be found on your left.

WILCOX-COON CEMETERY (Section 5)

Follow directions for Clarksville cemetery and continue on 2500N until you have crossed 1925E. Watch closely for this cemetery on your left (south). It is close to the road, BUT in the trees and difficult to find.

ZION-BISHOP CEMETERY (Section 29)

Take I-55 north to Towanda exit. After exiting, turn left (north) on 1900E. At 2100N turn right (east) and drive a short distance to the cemetery. It will be on your left (north) and is marked.

| | | | | | | |
|------------|-------------|-------------|-------------|------------|-------------|--------------|
| | | | GRIDLEY | CHENOA | YATES | |
| | | HUDSON | MONEY CREEK | LEXINGTON | LAW-DALE | CROFTS |
| DANVER | DRY GROVE | NORMAL | TOWANDA | BLUE MOUND | MARTIN | ANCHOR |
| ALLIN | DALE | BLOOMINGTON | OLD TOWN | JANSON | ARROW SMITH | CHENEY GROVE |
| MOUNT HOPE | PUNKS GROVE | RAN-DOLPH | DOWNS | EMERZ | WEST | PELL-LOWER |

MONEY CREEK

T.25 N. - R.3 E.

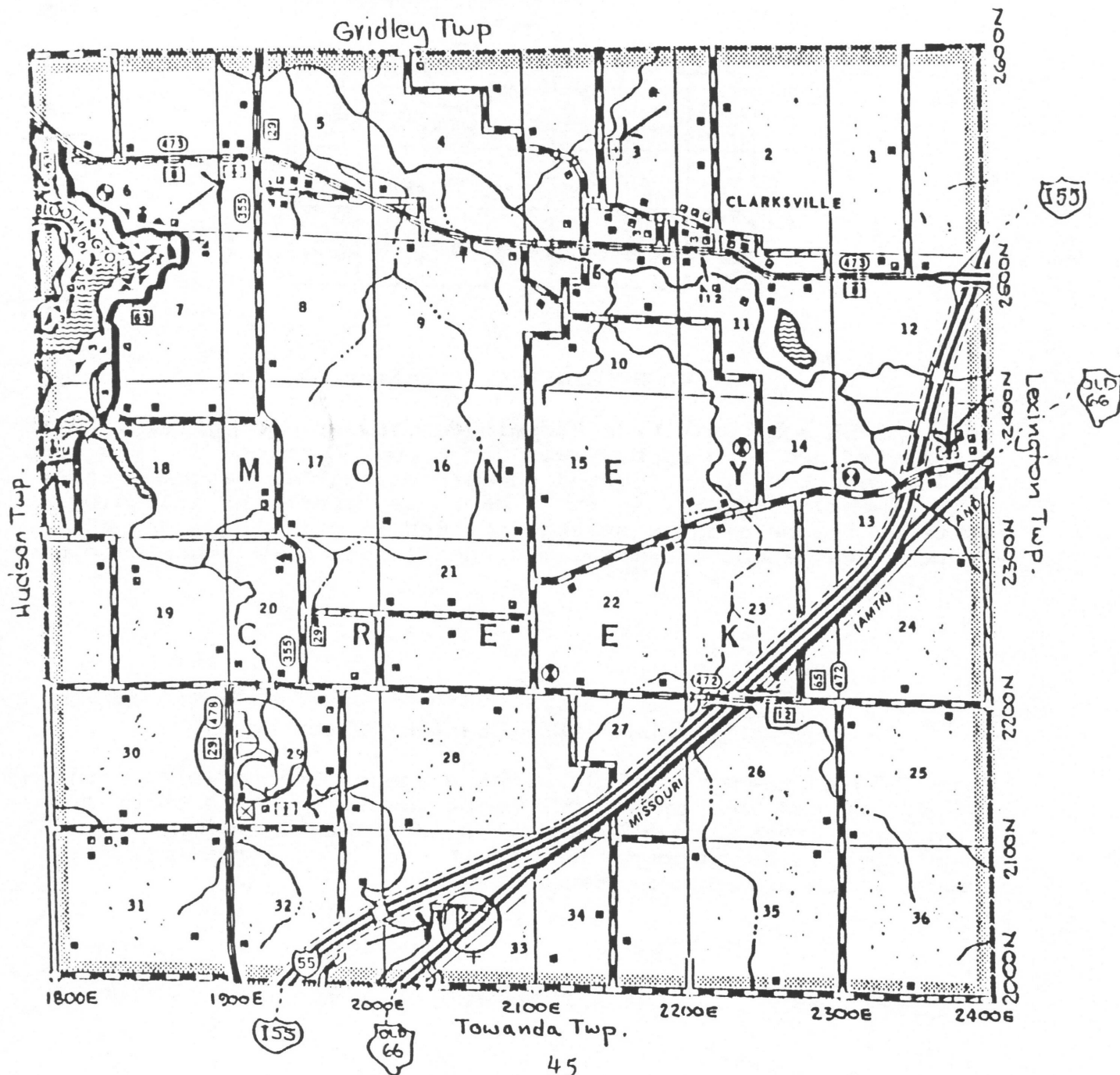

MOUNT HOPE TOWNSHIP T.21-22N - R.1W

McLEAN COUNTY ILLINOIS

| | | | | | | | |
|---------------|-----------------|------------------|-------------|----------------|----------------|-----------------|--------|
| | | | BRIDLEY | CHEMOA | YATES | | |
| | | WHITE OAK | HUDSON | MONEY CREEK | LEX- INGTON | LAWN- DALE | CROPSY |
| DANVERS | DRY GROVE | NORMAL | TOMANDA | BLUE MOUND | MARTIN | ANCHOR | |
| ALLIN | DALE | BLOOM- INGTON | OLD TOWN | DAWSON | ARROW SMITH | CHENEY GROVE | |
| MOUNT HOPE | PUNKS- GROVE | RAN- DOLPH | DOWNES | EMPIRE | WEST | PELL- LOWER | |

KAMPF CEMETERY (Section 6)

Follow I-55 southwest from Bloomington toward Springfield. Exit at Shirley and turn right (west) on 850N. Continue on this road to 500E and turn left (south) for 1/2 mile; then, at 800N, turn right (west) to 000E. At the time these directions are being written, the next short stretch of road is gravel. Turn left (south) and, about one mile away, you'll see the cemetery on your left (east).

McLEAN/MOUNT HOPE CEMETERY (Section 34)

Take I-55 southwest from Bloomington toward Springfield. Exit at McLean and continue on to your right (west) to the edge of town. Turn right (north) on 400E and then left (west) on 250N. The cemetery will be on your left (south) and has large entrance gates, which are easily seen.

MOUNT HOPE

T.21-22N. - R.1W.

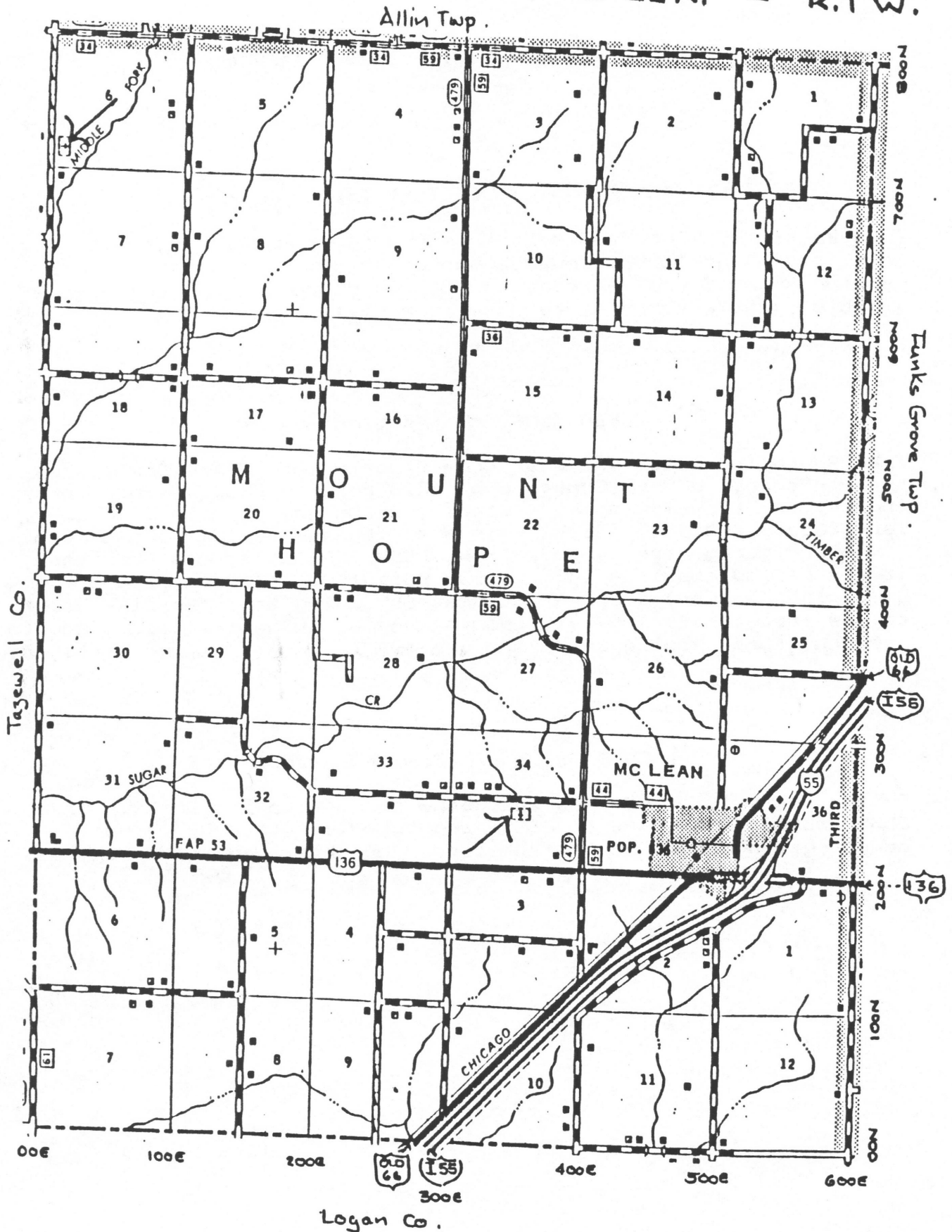

OLD TOWN TOWNSHIP T.23N - R3E

BISHOP FAMILY CEMETERY (Section 30)

Take Route 150 south and east from Bloomington toward Downs. Turn left (north) at 1900E (Iowanda-Barnes Road). Drive to the rear parking area of the gas station on this corner. The cemetery is visible, just a short distance up the hill.

LEBO CEMETERY (Section 36)

Take Route 150 south and east from Bloomington to the Downs area; turn left onto 800N. Continue on this road to 2400E. Turn left (north) and travel a short distance, watching for a lane on your left (west), which leads back to some storage buildings. A farm house and garage are on your right (east), just across from the lane. Follow the lane left to the buildings and park. Walk to your right (north) along the trees, following the tree line around to the left (west) and left (south) again, which will allow you to see the stones and fence in the grove.

PLEASANT GROVE CEMETERY (Section 27)

Follow Route 150 south and east from Bloomington to Downs. Take 800N (east) from Downs to 2200E and turn left (north). The cemetery and church are at the corner of this road and 1000N.

| | | | | | |
|------------|-------------|--------------|--------------|------------|-------------|
| | | GRIDLEY | WENOA | TATES | |
| | WHITE OAK | JUDSON | MOHNEY CREEK | IZI-INGTON | LAWN-DALE |
| WINTER | DRY GROVE | NORMAL | TOWANDA | BLUE MOUND | MARTIN |
| ALLIN | DALE | BLOOM-INGTON | OLD TOWN | WATSON | ARROW SMITH |
| MOUNT ROSE | PUNKS GROVE | PAN-DOLPH | DOWNS | EMPIRE | WEST |
| | | | | | PELL-LOWER |

OLD TOWN

T. 23 N. — R. 3 E.

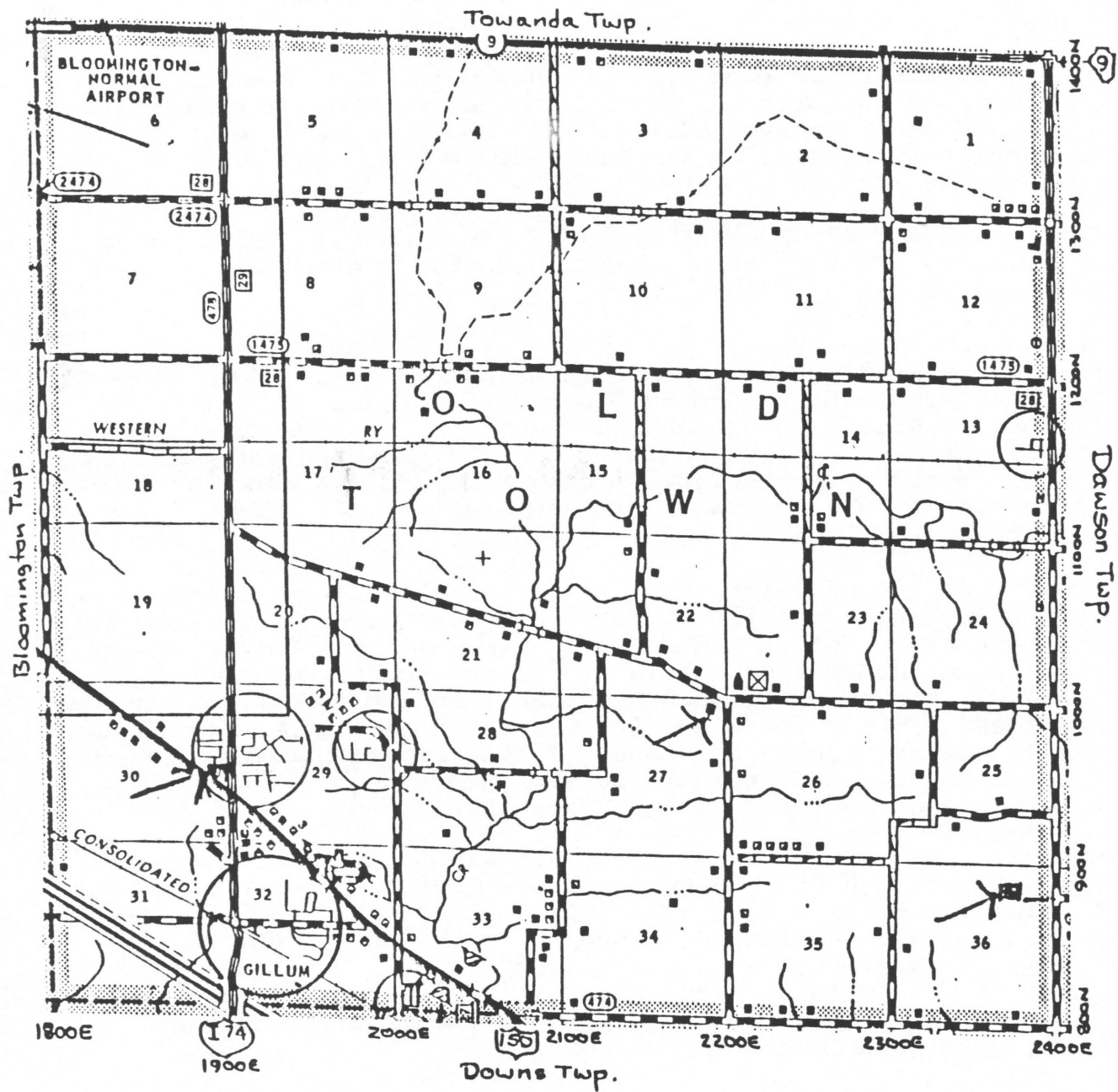

RANDOLPH TOWNSHIP T.21-22N - R.2E

For all cemeteries, take Rte. 51 South from Bloomington.

HEYWORTH CEMETERY (Section 34). At Heyworth, exit on Rte. 136 to the east. Continue on 136, also called Cleveland Ave., until you cross the railroad tracks. At the next cross street (Poland), turn left (N). Follow Poland St. to the cemetery.

MILLER CEMETERY (Section 26). At Heyworth, take Rte. 136 to the east through Heyworth. Continue on 136 to 1700E. Turn left (N) and cross 300N. Travel .3 of a mile and turn left (W). There is a green metal sign at the entrance to a narrow road. The cemetery is straight ahead.

RANDOLPH TOWNSHIP MEMORIAL CEMETERY (Section 21) (Also known as Passwater). Exit at 400N to the left (E). Follow the road to the cemetery on your left (N).

SHILOH CEMETERY (Section 25). Exit at Rte. 136 to Heyworth. Follow 136 east to 1700E, turn left (N) and go to 300N. Turn right (E) and continue on 300N watching for the next left turn (1775E). After turning left (N) on 1775E, the road winds and, shortly after two right angle turns, the cemetery lane will be on your left (W). The lane is marked by a green metal sign. The grassy lane is driveable in dry weather. The cemetery is at the end of the lane.

SPAID - BISHOP CEMETERY (Section 27). Watch for 400N and turn left (E). Pass Randolph Township Memorial Cemetery on your left and turn right (S) at old Rte. 51. You will see Carter Lumber Company buildings and equipment. At the southern edge (town side) of this area, turn on graveled lane and proceed across the railroad tracks. Leave car and walk through field along fence until you reach grove of trees. Follow right (S) along edge of grove and, near the southern edge of grove, you will find the cemetery area enclosed with a black iron fence.

STEWART CEMETERY (Section 15). Pass signs marking Crestwicke, Shirley Road and Country Acres. Turn left (E) on Randolph Road. At old 51 stop sign, jog left (N) on 51 and then right on to County Rd. 36. Follow 36 to stop sign and turn right (S) on 1550N. At next stop sign, turn left (E) on 550N and, after about .2 of a mile, a large home will appear on your left. The cemetery entrance is on your right (S), marked with a sign. Park, open gates and walk to cemetery.

Bloomington Twp.

1-32
Sveve
Ks

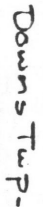

TOWANDA

T. 24 N. - R. 3 E.

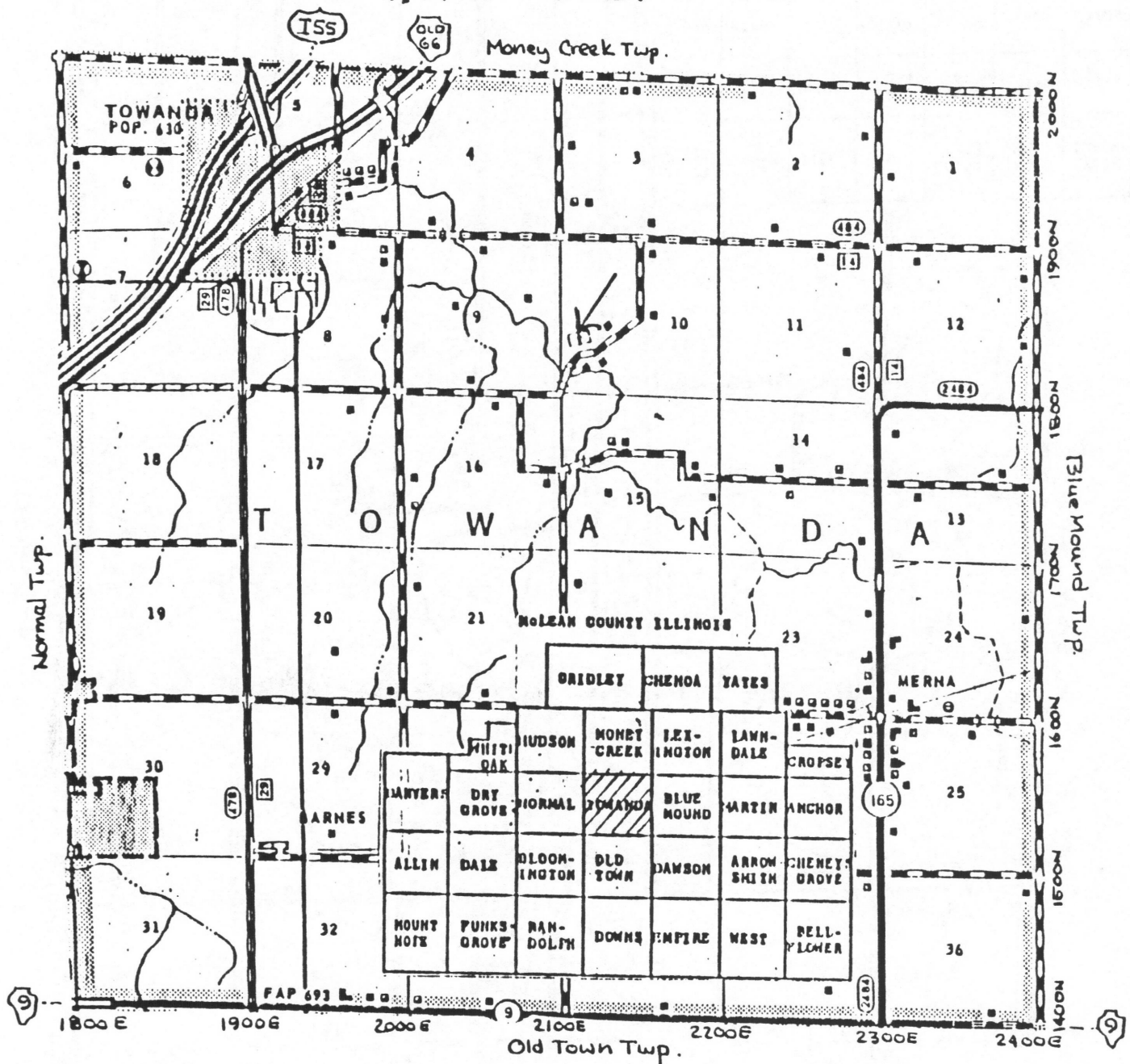

SMITHS GROVE CEMETERY (Section 10)

- Travel east from Bloomington on Route 9. Turn north (to your left) on 1900E, also known as Towanda-Barnes road. Watch for 1800N. You will turn right (east) and follow this road about 2-plus miles to the cemetery. As you near the cemetery, the road will curve and you will go across a bridge, drive in a wooded area and up a slight incline, where you will see the site on your left. It is marked with a large boulder.

WEST

T. 21-22 N. - R. 5 E.

| | | | | | | |
|------------|-------------|--------------|-------------|------------|-------------|---------------|
| | | GRIDLEY | CHENOA | YATES | | |
| | WHITE OAK | HUDSON | MONEY CREEK | LEX-INGTON | LAWN-DALE | CROPSEY |
| DANVERS | DRY GROVE | NORMAL | TOWANDA | BLUE MOUND | MARTIN | ANCHOR |
| ALLIN | DALE | BLOOM-INGTON | OLD TOWN | DAWSON | ARROW-SMITH | CHENEYS GROVE |
| MOUNT HOFE | FUNKS GROVE | RAN-DOLPH | DOWN | EMPIRE | WEST | BELL-FLOWER |

No cemeteries in this township.

WHITE OAK TOWNSHIP T.25N - R.1E

DENMAN CEMETERY (Sections 15 and 22)

Take I-39 north from Bloomington-Normal, exit at Hudson and turn left (go under I-39) and continue west on 2200N. Turn right (north) at 1200E and take the next left (west) turn onto 2250N. The cemetery is on 950E. You will turn right (north) and, after a short winding drive, the cemetery will appear on your right.

ROPP CEMETERY (Section 25)

Follow directions for Denman Cemetery and, when you arrive at intersection of 2200N and 1200E, turn left (south) onto 1200E. Continue on and turn right (west) at 2100N and the cemetery is a short distance down the road. A sign over the entry will be easily seen on the right (north) side of the road.

TROYER CEMETERY (Section 34)

Use same route as to Ropp Cemetery. Continue on west past the cemetery on 2100N. The Troyer Cemetery is at the intersection of 2100N and 1000E. There are signs on the north and east sides of the cemetery.

WINTZ CEMETERY (Section 31)

Take I-74 or Route 150 west from Bloomington to Carlock. The cemetery is on the west side of the interstate highway. Take 2050N to the west out of Carlock, over I-74, and the cemetery is a short distance from the overpass. It lies on the right (north) side of the road. A sign marks the entrance.

| | | GRIDLEY | CHENOA | TATES | |
|------------|-------------|-------------|-------------|------------|------------|
| | | HUDSON | HONEY CREEK | LEXINGTON | JAMM-DALR |
| WINTER | DRY GROVE | FORMAL | MCMAID | BLUE MOUND | MARTIN |
| ALLIN | DALE | MOON-INGTON | OLD TOWN | JANSON | ARROW BUSH |
| MOUNT HOIS | PUNKS GROVE | PAH-DOLPH | DOYNS | EMPIRE | WEST |
| | | | | | PELL-LONER |

WHITE OAK

T.25 N. - R.1 E.

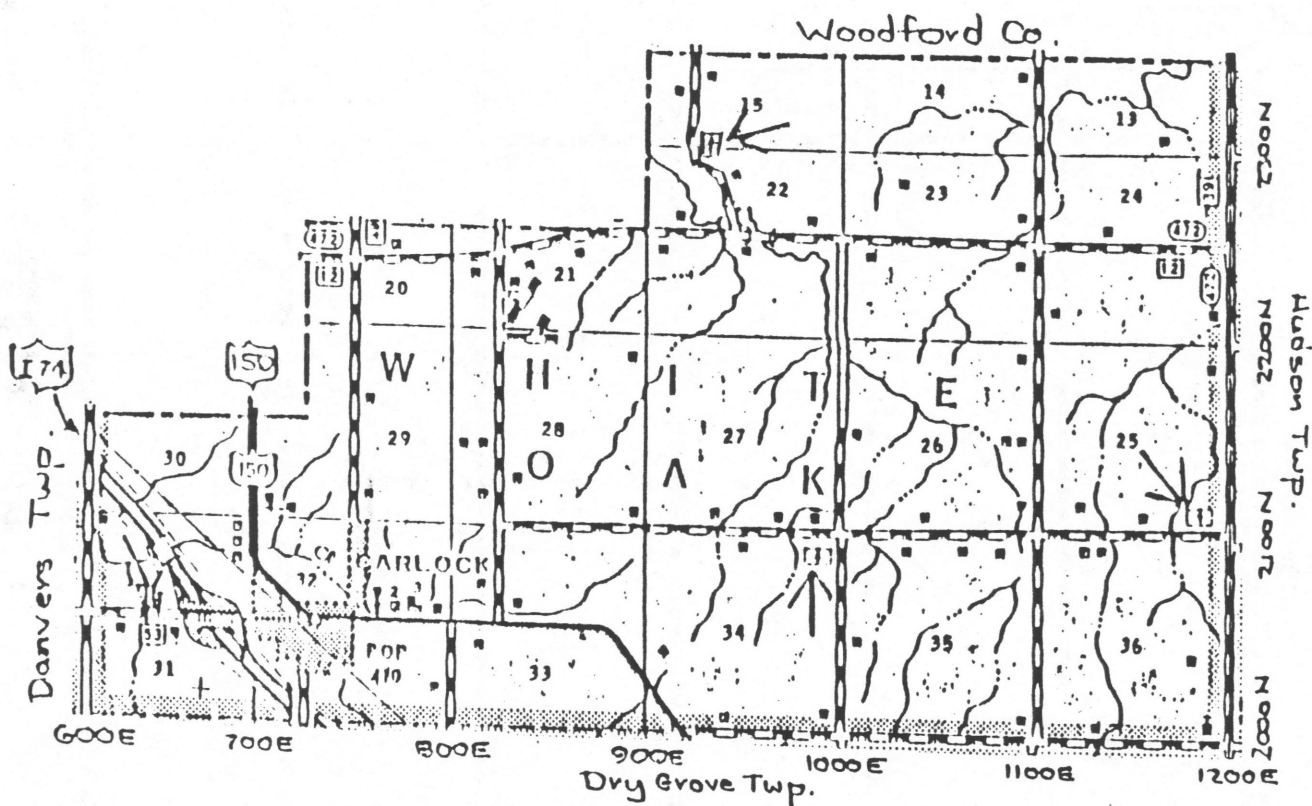

McLEAN COUNTY ILLINOIS

YATES

T. 26N. - R. 5 E.
Livingston Co.

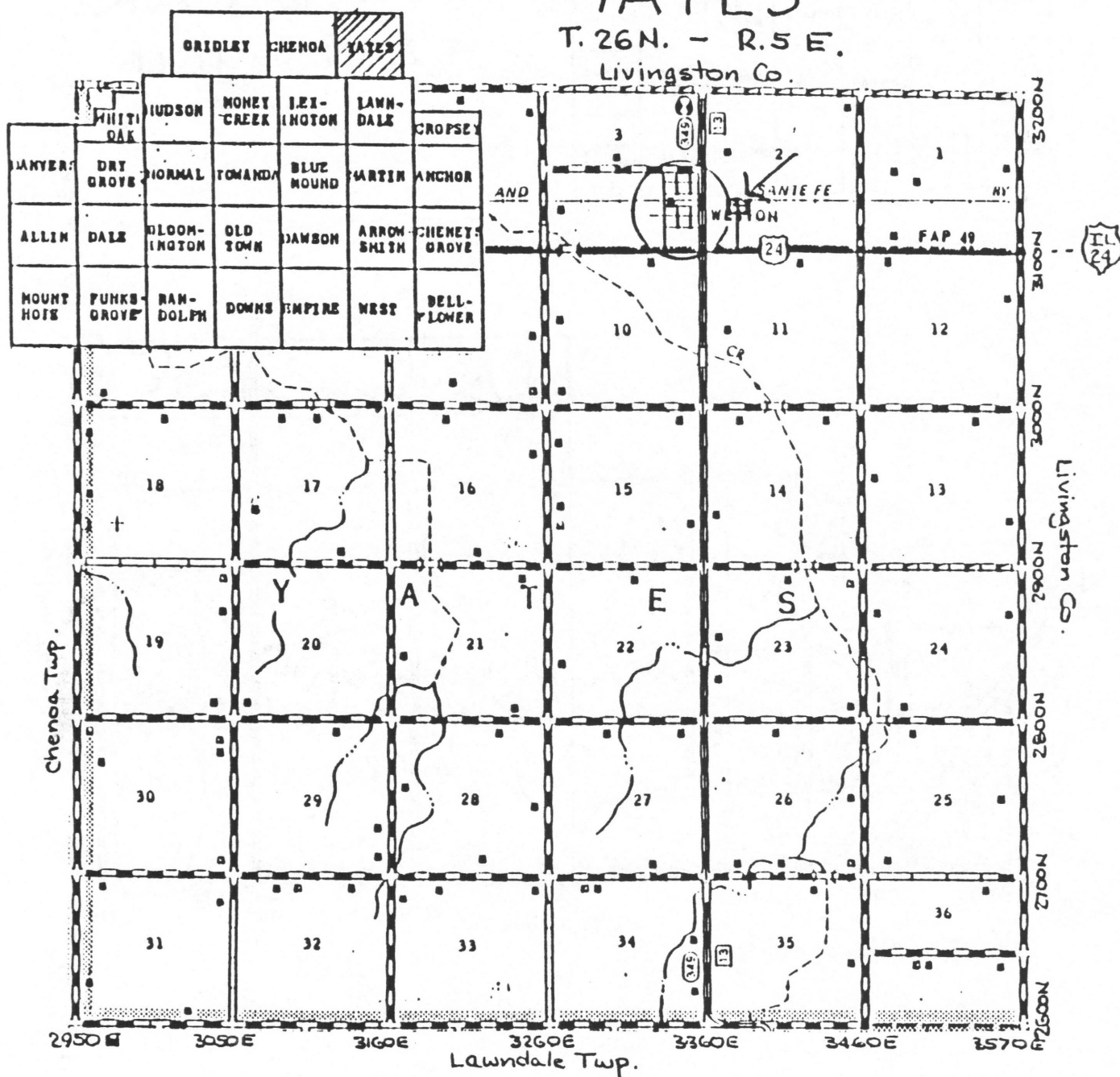

WESTON CEMETERY (Section 2)

Take I-55 north from Bloomington-Normal to Chenoa, IL. Take the exit and continue to the right (east) on US 24 toward Weston. This cemetery is located in a State of Illinois Nature Preserve. Shortly after passing the Weston road, you will see a Nature Preserve sign along the highway and to your right. Turn left (north) and the cemetery will be at the end of the grassed lane.

ADDENDUM

MCLEAN COUNTY CEMETERY LOCATIONS

The following cemeteries and family burial sites do not have public access. Therefore no specific directions to them are given. The township and section is listed and we suggest that you ask permission of land owners before attempting to reach these areas. Some restoration work has been done in a few sites and some is planned in others.

DANVERS TWP

Hinshaw-Skaggs Cemetery. W 1/2 of NW 1/4, Section 22. This cemetery has 50 + stones and is in very poor shape. Stones are down and broken, some partially sunken etc. Weeds, briars and daylilies cover the entire area.

DAWSON TWP

Wilcox (Bunn) family burials. SE 1/4 of Section 32. Broken stones. little information visible.

DOWNS TWP

Johnson family burials, SW 1/4 of Section 25. Stones recently restored.

EMPIRE TWP

Deffenbaugh family burials, SE 1/4 of Section 5.(south) Two restored stones.

Minor Bishop burial site, SW 1/4 of Section 16. One stone.

MT. HOPE TWP

Chapin family burials, NE corner of SW 1/4 of Section 32. All stones are down and broken or chipped. Cattle have access to the area but the area has been kept in pasture.

Longworth Cemetery, NE 1/4 of NW 1/4 of Section 32. The stones are broken, partially underground etc. The freezing and thawing causes this site to have stones disappear and resurface from year to year. Cattle have access to the area as a part of their feed lot.

Old Mount Hope Cemetery, SW corner of NE 1/4 of Section 4. A few broken stones piled together are surrounded by crops.

OLD TOWN TWP

Mannen family burials. S of RR, at eastern edge of SW 1/4 of Section 32. Stone recently restored as Eagle Scout project.

INDEX

| Cemetery | page |
|---------------------------------|------|
| Adams Family ----- | 40 |
| Anchor Township ----- | 4 |
| Antloch ----- | 42 |
| Arrowsmith (Stipp-Union) ----- | 6 |
| Barnard (Hall) ----- | 28 |
| Barnes ----- | 24 |
| Bellflower Township ----- | 8 |
| Benjaminville ----- | 24 |
| Bishop Family ----- | 48 |
| Blooming Grove ----- | 10 |
| Blue Mound ----- | 14 |
| Brock ----- | 32 |
| Brooks Grove ----- | 2 |
| Cheneys Grove Township ----- | 16 |
| Chenoa ----- | 18 |
| Clarksville ----- | 44 |
| County Farm ----- | 10 |
| Cropsey ----- | 19 |
| Dawson (Dawson Twp.) ----- | 24 |
| Dawson (Money Creek Twp.) ----- | 44 |
| Denman ----- | 54 |
| Diamond Grove ----- | 26 |
| East Lawn Memorial Park ----- | 12 |
| East Twin Grove ----- | 28 |
| Evergreen ----- | 38 |
| Evergreen/Old City ----- | 10 |
| Frankeberger ----- | 24 |
| Fremont ----- | 32 |
| Funks Grove ----- | 32 |
| Gilmore ----- | 30 |
| Gilston/Christian Church ----- | 28 |
| Grassy Ridge ----- | 10 |
| Greenwood ----- | 6 |
| Gridley ----- | 34 |
| Havens ----- | 36 |
| Heyworth ----- | 50 |
| Hinthorn ----- | 44 |
| Holy Cross (Merna) ----- | 14 |
| Holy Cross (Normal) ----- | 12 |
| Hopewell ----- | 26 |
| Howard ----- | 30 |
| Hudson ----- | 36 |
| Imhoff ----- | 22 |
| Indian Field ----- | 40 |
| Jewish ----- | 10 |
| Kampf ----- | 46 |
| Kaufman ----- | 36 |

| | |
|--|-------|
| Lantz ----- | 28 |
| Lawndale ----- | 38 |
| Lawndale Lutheran ----- | 38 |
| Lebo ----- | 48 |
| Lexington ----- | 40 |
| Mount Hope ----- | 46 |
| Mc Naught ----- | 34 |
| Messer ----- | 36 |
| Miller ----- | 48 |
| Mount Pleasant ----- | 2 |
| North Danvers Mennonite ----- | 22 |
| Oak Grove ----- | 30 |
| Old Oak Grove ----- | 30 |
| Park Hill ----- | 10 |
| Park Lawn ----- | 22 |
| Payne ----- | 6 |
| Peasley ----- | 26 |
| Pennell ----- | 44 |
| Pleasant Grove ----- | 48 |
| Pleasant Hill ----- | 40 |
| Plymouth ----- | 42 |
| Price Farm ----- | 10 |
| Randolph Memorial Park (Passwater) ----- | 50 |
| Riverside ----- | 16 |
| Ropp ----- | 54 |
| Rutledge ----- | 26 |
| Scogin Hill ----- | 12-20 |
| Scrogin ----- | 40 |
| Shiloh ----- | 50 |
| Shirley ----- | 20 |
| Smith Grove ----- | 52 |
| Spald-Bishop ----- | 50 |
| St. John's Lutheran ----- | 4 |
| St. Joseph's Catholic ----- | 12 |
| St. Mary's Catholic ----- | 12 |
| Stewart ----- | 50 |
| Stouts Grove ----- | 22 |
| Troyer ----- | 54 |
| West Twin Grove (Rosewood) ----- | 28 |
| West Union (Mitchell) ----- | 22 |
| Weston ----- | 56 |
| Wilcox-Coon ----- | 44 |
| Wiley ----- | 42 |
| Wiley Family ----- | 40 |
| Wilson ----- | 28 |
| Wintz ----- | 54 |
| Woodlawn (Rhodes) ----- | 12 |
| Zion-Bishop ----- | 44 |